

NOTES

THE BASIS OF BEARING IS THE NORTH LINE OF THE N.E. 1/4 OF SECTION 15, T.27N., R.13E., M.D.B.&M., GIVEN AS S89°48'21"W ON THAT CERTAIN RECORD OF SURVEY MAP FILED JUNE 3, 1966, IN BOOK 3 OF RECORD OF SURVEYS AT PAGE 68, RECORDING NO.4534, IN THE OFFICIAL RECORDS OF THE COUNTY OF PLUMAS, STATE OF CALIFORNIA.

TOTAL ACREAGE 40.71 AC.

SURVEYOR'S CERTIFICATE

THIS MAP CORRECTLY REPRESENTS A SURVEY MADE BY ME OR UNDER MY DIRECTION IN CONFORMANCE WITH THE REQUIREMENTS OF THE LAND SURVEYOR'S ACT AT THE REQUEST OF RONALD L. HEIDRICH, FRED M. MARSEILLE, GLENN D. MOSLEY, AND D.E. BAUGUS IN JULY, 1967. THIS RECORD OF SURVEY IS EXCLUDED FROM THE SUBDIVISION MAP ACT BY SECTION 11535, ARTICLE 3, CHAPTER 2, OF THE BUSINESS AND PROFESSIONAL CODE.

Edward P. Norris  
EDWARD P. NORRIS, L.S. 2846

LEGEND

- COMPUTED CORNER LOCATION
- SET HUB & TACK
- SET 3/4" IRON PIPE MARKED RCE 7294
- FOUND CORNER AS INDICATED
- FOUND SECTION CORNER AS INDICATED

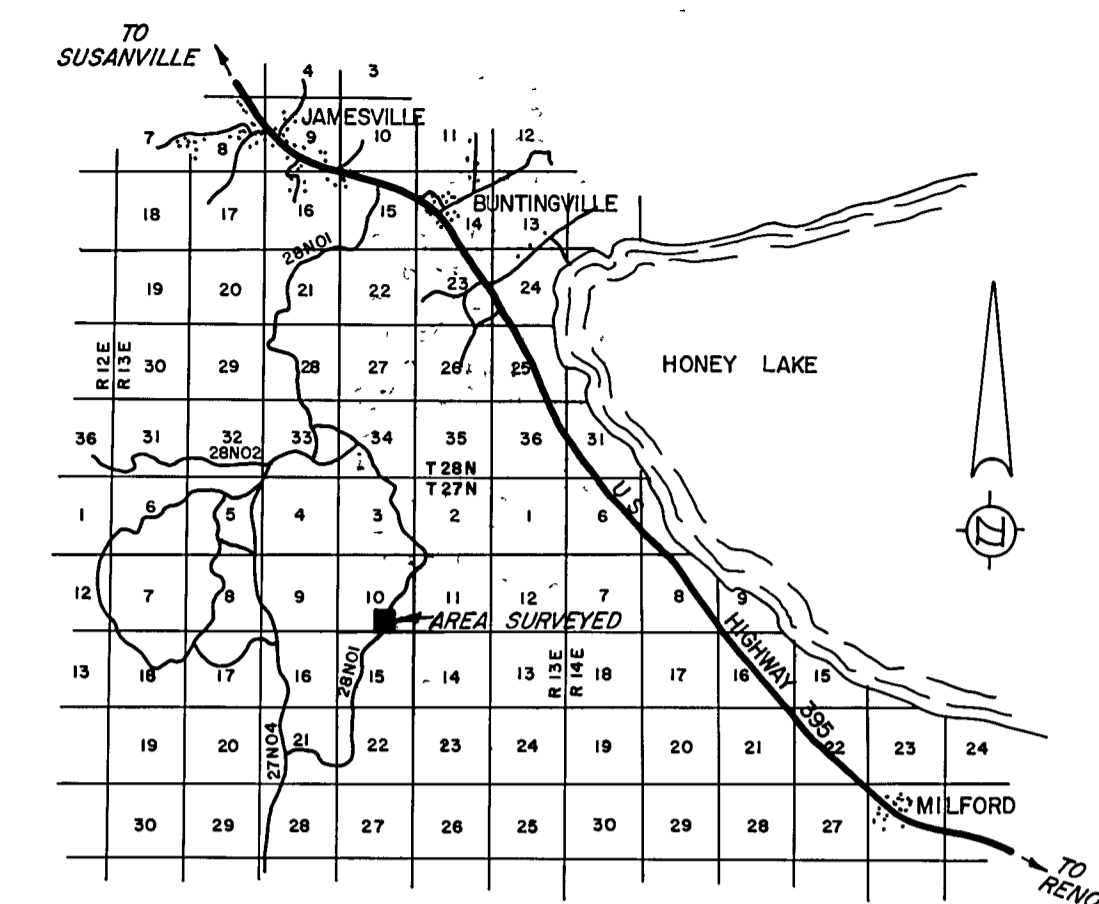

LOCATION MAP

SCALE: 1" = 2 1/2 Miles

COUNTY ENGINEER'S CERTIFICATE

THIS MAP HAS BEEN EXAMINED FOR CONFORMANCE WITH THE REQUIREMENTS OF THE LAND SURVEYOR'S ACT THIS 11<sup>th</sup> DAY OF October, 1967.

Lawrence J. Brock  
LAWRENCE J. BROCK, R.C.E. 13528

RECORDER'S CERTIFICATE

FILED FOR RECORD THIS 13<sup>th</sup> DAY OF October, 1967, AT 11:57AM IN BOOK 3 OF RECORD OF SURVEYS AT PAGE 46 AT THE REQUEST OF WALTER B. GRIMES. RECORDING NO. 1800.

FEE 5.00

Walter B. Grimes  
COUNTY RECORDER

BY \_\_\_\_\_ DEPUTY

RECORD OF SURVEY MAP

THE S.W. 1/4 OF THE S.E. 1/4 OF SECTION 10, T.27N., R.13E., M.D.B.&M. PLUMAS COUNTY, CALIFORNIA

SURVEY OF THE LANDS OF RONALD L. HEIDRICH, FRED M. MARSEILLE, GLENN D. MOSLEY, & D.E. BAUGUS

SCALE: 1" = 200'

JULY, 1967

WALTER B. GRIMES ASSOC.  
CIVIL ENGINEERS & LAND SURVEYORS  
1356 MANGROVE AVENUE, CHICO, CALIFORNIA

