

SURVEYOR'S CERTIFICATE

THIS MAP CORRECTLY REPRESENTS A SURVEY MADE BY ME OR UNDER MY DIRECTION IN CONFORMANCE WITH THE REQUIREMENTS OF THE LAND SURVEYOR'S ACT AT THE REQUEST OF WELLS FARGO BANK IN OCTOBER, 1967. THIS RECORD OF SURVEY IS EXCLUDED FROM THE SUBDIVISION MAP ACT BY SECTION 11535, ARTICLE 3, CHAPTER 2, OF THE BUSINESS AND PROFESSIONAL CODE.

Edward P. Norris
EDWARD P. NORRIS, L.S. 2846

COUNTY ENGINEER'S CERTIFICATE

THIS MAP HAS BEEN EXAMINED FOR CONFORMANCE WITH THE REQUIREMENTS OF THE LAND SURVEYOR'S ACT THIS 25th DAY OF OCTOBER, 1967.

Lawrence J. Brock
LAWRENCE J. BROCK, R.C.E. 13528

RECORDER'S CERTIFICATE

FILED FOR RECORD THIS 25th DAY OF October, 1967, AT 2:30 P.M. IN BOOK 3 OF RECORD OF SURVEYS AT PAGE 100 AT THE REQUEST OF WALTER B. GRIMES. RECORDING NO. 2046

FEE 5.00

Ida Lagan Gronwald
COUNTY RECORDER

BY _____
DEPUTY

NOTES

THE BASIS OF BEARING IS THE SOUTHEASTERLY LINE OF THE COUNTY ROAD, GIVEN AS NORTH 68°55' EAST IN THAT CERTAIN DEED FILED MARCH 14, 1961, IN VOLUME 143 AT PAGE 152 IN THE PLUMAS COUNTY OFFICIAL RECORDS, FILE NO. 2854.

LEGEND

- FOUND 1/4 SECTION CORNER
- FOUND POINT AS DESIGNATED
- ⊗ SET 3/4" IRON PIPE MARKED RCE 7294
- ✕ SET NAIL & TIN MARKED RCE 7294
- COMPUTED CORNER LOCATION

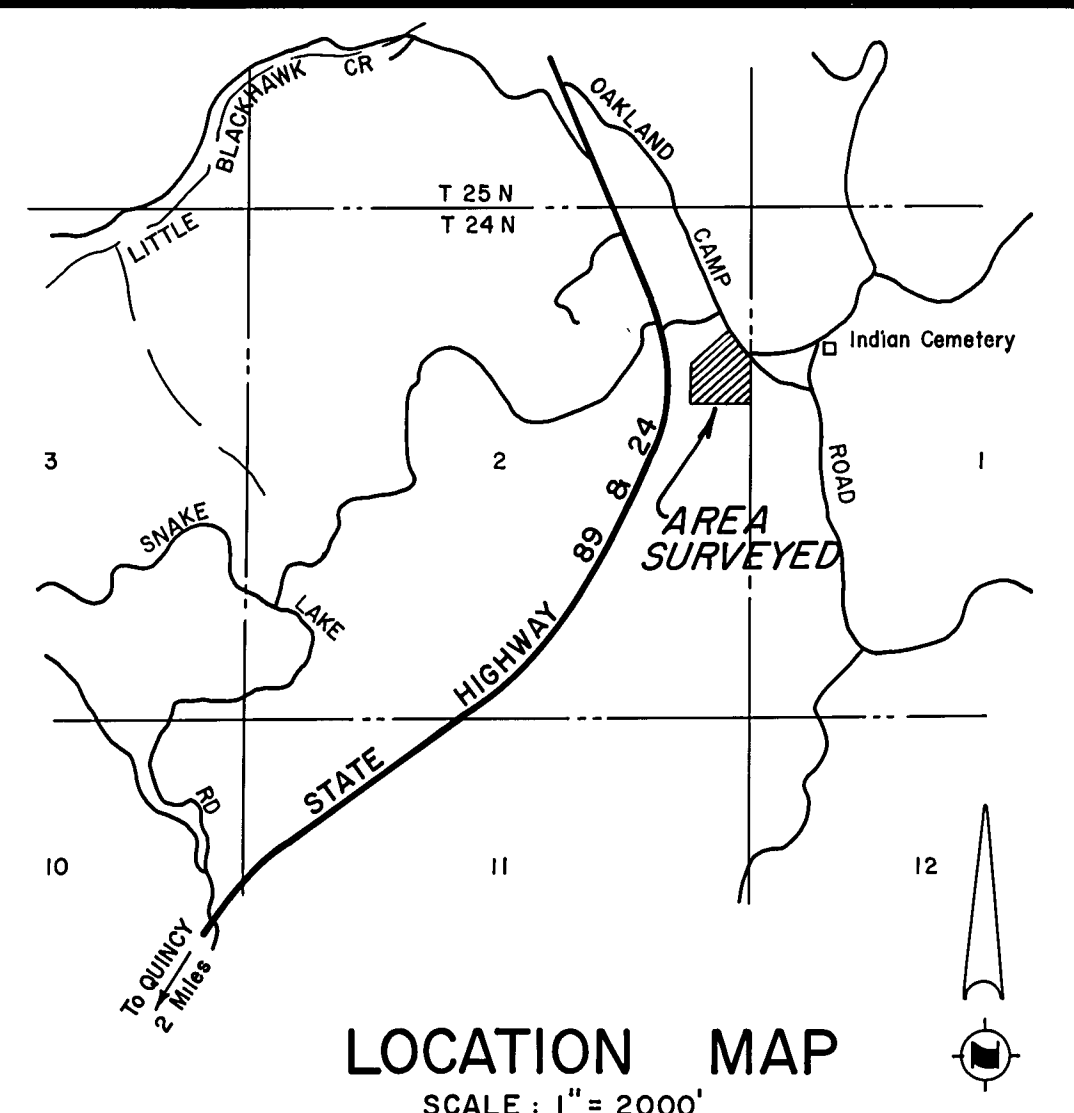

RECORD OF SURVEY MAP
A PORTION OF THE N.E. 1/4 OF
SECTION 2, T.24N., R.9E., M.D.B.&M.
PLUMAS COUNTY, CALIFORNIA

SURVEY OF THE LANDS OF
WELLS FARGO BANK
SCALE: 1" = 100' OCTOBER, 1967

G WALTER B. A
RIMES ASSOC.
CIVIL ENGINEERS & LAND SURVEYORS
1356 MANGROVE AVENUE, CHICO, CALIFORNIA