

FOUND 1/16 CORNER (1" TAG WITH A BEARING AND DISTANCE FROM A HUB AT THE EDGE OF THE ROAD) BEARS WEST 22.5 FT. FROM PROTRACTED POSITION OF 1/16 CORNER.

FOUND CORNER (SMALL MOUND AND PIPE W/L.S. TAG #2322 IN SHOULDER OF ROAD) 1.0 S. 7.5 N 89°30' E = 57 LKS. W/ OPEN BLAZE 5+1 I LEGIBLE IN SHOULDER OF ROAD) BEARS S 89°43' W 46.4 FT. FROM PROJECTED POSITION OF CLOSING CORNER.

CURVE DATA			
CURVE NO	RADIUS FT	CENTRAL ANGLE ° I H	ARC FT
58	350	69 00 00	421.50
58A	"	15 46 15	96.34
58B	"	53 13 45	325.16
59	200	66 00 00	230.38
60	100	75 00 00	130.90
61	125	63 06 00	187.64
62	200	74 00 00	258.31
63	125	48 00 00	104.72
64	500	37 00 00	322.89
64A	"	10 34 55	92.34
64B	"	26 25 05	230.54
65	100	119 00 00	207.65
66	100	122 00 00	212.95
66A	"	66 17 52	115.71
66B	"	55 42 08	97.22
67	250	36 00 00	157.08
68	250	60 00 00	261.00
69	100	80 00 00	139.63
70	100	69 00 00	120.43
71	150	92 00 00	136.14
72	350	69 00 00	421.50
73	200	50 00 00	174.53
74	300	30 00 00	137.08
75	150	41 00 00	159.70
76	400	17 00 00	118.66
77	300	48 00 00	251.35
78	400	35 00 00	244.35
79	75	127 00 00	166.24
80	400	24 00 00	251.35
81	100	75 00 00	130.90
82	800	24 00 00	224.89

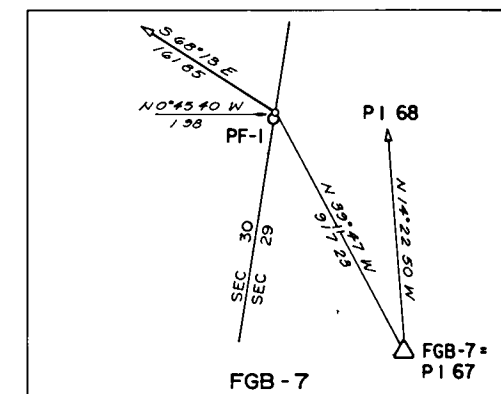
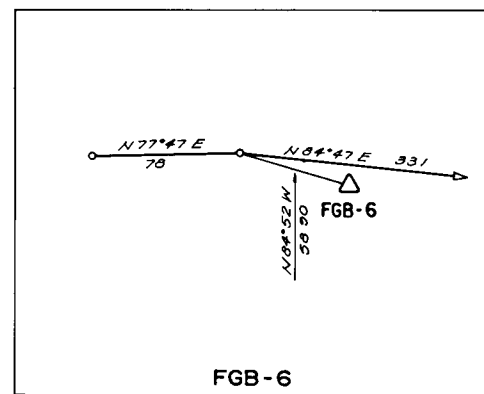

LOCAL TIES
SCALE 1" = 100'

LEGEND

- FOUND PROPERTY CORNER OR 1/4 SECTION CORNER
- ⊕ FOUND SECTION CORNER
- ⊠ SERIAL NUMBER FOR FOUND CORNERS SEE SHEET I FOR ACCOMPANYING DESCRIPTION
- ⊕ PROTRACTED OR PROJECTED CORNER
- △ SURVEY CONTROL MONUMENT WITH U.S.F.S. TABLET
- BOUNDARY OF PRIVATE LAND (FRUIT GROWERS)

NOTE

RECORD BEARINGS AND / OR DISTANCES ARE SHOWN IN PARENTHESIS, ALL OTHER DATA ARE CALCULATED

This plat was photogrammetrically compiled from vertical aerial photographs by Greenwood and Associates and meets the specifications prepared by the U. S. Forest Service. The photogrammetric survey of Road No. 28N03 involved the securing of vertical aerial photography, the establishment of horizontal control, compilation of a planimetric map, projection and projection of the land net from recovered and tied-in authentic property corners and plotting and calculation of centerline position and description.

All data pertinent to this survey is on file at the following address:

U. S. Forest Service
Division of Engineering
Surveys and Maps Branch
630 Sansome Street
San Francisco, California 94111

U. S. FOREST SERVICE
PLAT OF
ROAD NO. 28N03
FRUIT GROWERS BOULEVARD
PLUMAS NATIONAL FOREST
PLUMAS COUNTY, CALIFORNIA
SCALE 1" = 400'
200 400 600 800
SHEET ⑤ OF 5