

EXISTING ROADS

1-2	N 48° 49' 26" W	290.65	42-43	N 12° 13' 15" W	289.34
2-3	N 82° 45' 31" W	130.72	43-44	N 77° 20' 58" W	200.77
3-4	S 75° 51' 29" W	119.13	44-45	N 77° 20' 58" W	188.31
4-5	N 76° 03' 51" W	110.67	45-46	N 41° 33' 03" W	284.69
5-6	S 80° 55' 29" W	92.66	46-47	N 50° 17' 17" W	403.17
6-7	S 68° 21' 09" W	306.09	47-48	N 14° 58' 50" W	116.57
7-8	S 60° 58' 54" W	295.37	48-49	N 14° 58' 50" W	220.50
8-9	S 79° 53' 19" W	131.75	49-50	N 33° 36' 55" W	533.37
9-10	S 79° 53' 19" W	68.40	50-51	S 48° 04' 19" W	423.67
10-11	S 89° 12' 55" W	440.65	51-52	N 86° 21' 32" W	345.82
11-12	S 77° 49' 49" W	404.33	52-53	N 15° 47' 30" W	56.63
12-13	S 88° 44' 09" W	415.07	53-54	N 15° 47' 30" W	339.71
13-14	N 68° 33' 00" W	27.48	54-55	N 66° 12' 48" W	234.44
14-15	N 68° 33' 00" W	185.91	55-56	N 40° 59' 25" W	318.48
15-16	N 50° 45' 50" W	249.05	56-57	N 23° 45' 40" W	193.43
16-17	N 67° 18' 50" W	267.95	57-58	N 46° 40' 30" W	171.97
17-18	N 52° 00' 40" W	91.82	58-59	N 25° 47' 15" W	214.10
18-19	N 21° 51' 00" W	162.53	59-60	N 53° 46' 15" W	223.87
19-20	N 64° 53' 50" W	342.13	60-61	N 38° 48' 15" W	67.45
20-A	N 71° 50' 46" W	303.45	61-62	N 38° 48' 15" W	107.84
A-21	N 71° 50' 46" W	191.44	62-63	N 38° 48' 15" W	59.61
21-22	N 28° 24' 30" W	25.86	63-64	N 27° 39' 41" W	612.46
22-23	N 28° 24' 30" W	161.50	64-65	N 43° 59' 12" W	344.11
23-24	N 48° 52' 47" W	600.50	65-66	N 28° 30' 30" W	102.92
24-25	N 71° 23' 05" W	245.25	66-67	N 42° 17' 36" W	438.62
25-26	N 48° 58' 45" W	240.97	67-68	S 81° 27' 40" E	196.73
26-27	S 80° 51' 55" W	147.17	68-69	N 66° 16' 40" E	99.59
27-28	S 33° 13' 05" W	89.21	69-70	S 77° 24' 21" E	398.87
28-29	N 28° 47' 16" E	116.88	70-71	S 68° 12' 15" E	198.80
29-30	N 83° 18' 45" E	298.30	71-72	S 78° 21' 30" E	145.91
30-31	N 50° 25' 00" E	206.48	72-73	S 66° 34' 00" E	95.10
31-32	N 73° 21' 20" E	64.54	73-74	S 59° 27' 40" W	164.65
32-33	S 85° 58' 10" E	167.11	74-75	S 35° 41' 10" W	569.82
33-34	S 85° 58' 10" E	18.27	75-76	S 77° 16' 30" W	247.86
34-35	N 82° 21' 19" E	375.79	76-77	S 77° 16' 30" W	34.90
35-36	N 82° 21' 19" E	108.33	77-78	S 44° 41' 09" W	288.54
36-37	N 53° 26' 27" E	481.26	78-79	S 44° 41' 09" W	56.20
37-38	N 67° 42' 15" E	202.45	79-80	S 60° 01' 07" W	432.99
38-39	N 31° 54' 20" E	180.33	80-81	N 79° 53' 25" W	165.22
39-40	N 61° 42' 30" E	129.28	81-82	N 53° 04' 32" W	370.58
40-42	N 26° 32' 04" E	508.39	82-83	N 53° 04' 32" W	275.65

ROAD TIES

NW 1/4	67	N 89° 39' 41" E	897.71'	
CW 1/4	62	N 0° 18' 26" W	83.43'	
CW 1/4	61	N 89° 35' 44" E	68.19'	
CS 1/4	53	S 89° 48' 36" W	234.60'	
CS 1/4	33	S 0° 24' 33" E	48.54'	
SW 1/4	A	S 0° 18' 26" E	83.04'	
SW 1/4	22	S 89° 48' 36" W	193.77'	
S 1/4	34/35-28	N 0° 12' 19" W	679.17'	
S 1/4	14	N 0° 24' 33" W	476.57'	
W 1/4	35	N 0° 18' 26" W	211.55'	
W 1/4	35	78	S 89° 41' 29" W	287.69'
SW Sec Cor	82	N 89° 41' 29" E	219.77'	
SW Sec Cor	83	N 0° 12' 19" W	166.79'	
CN 1/4	50	S 89° 47' 59" E	314.61'	
C 1/4	52	N 0° 24' 33" W	435.29'	
CE 1/4	44	N 0° 11' 26" W	97.17'	
SE 1/4	40	N 0° 11' 26" W	599.63'	
E 1/4	35	9	N 0° 13' 39" W	578.94'
SE Sec Cor	1	N 0° 02' 46" W	667.83'	

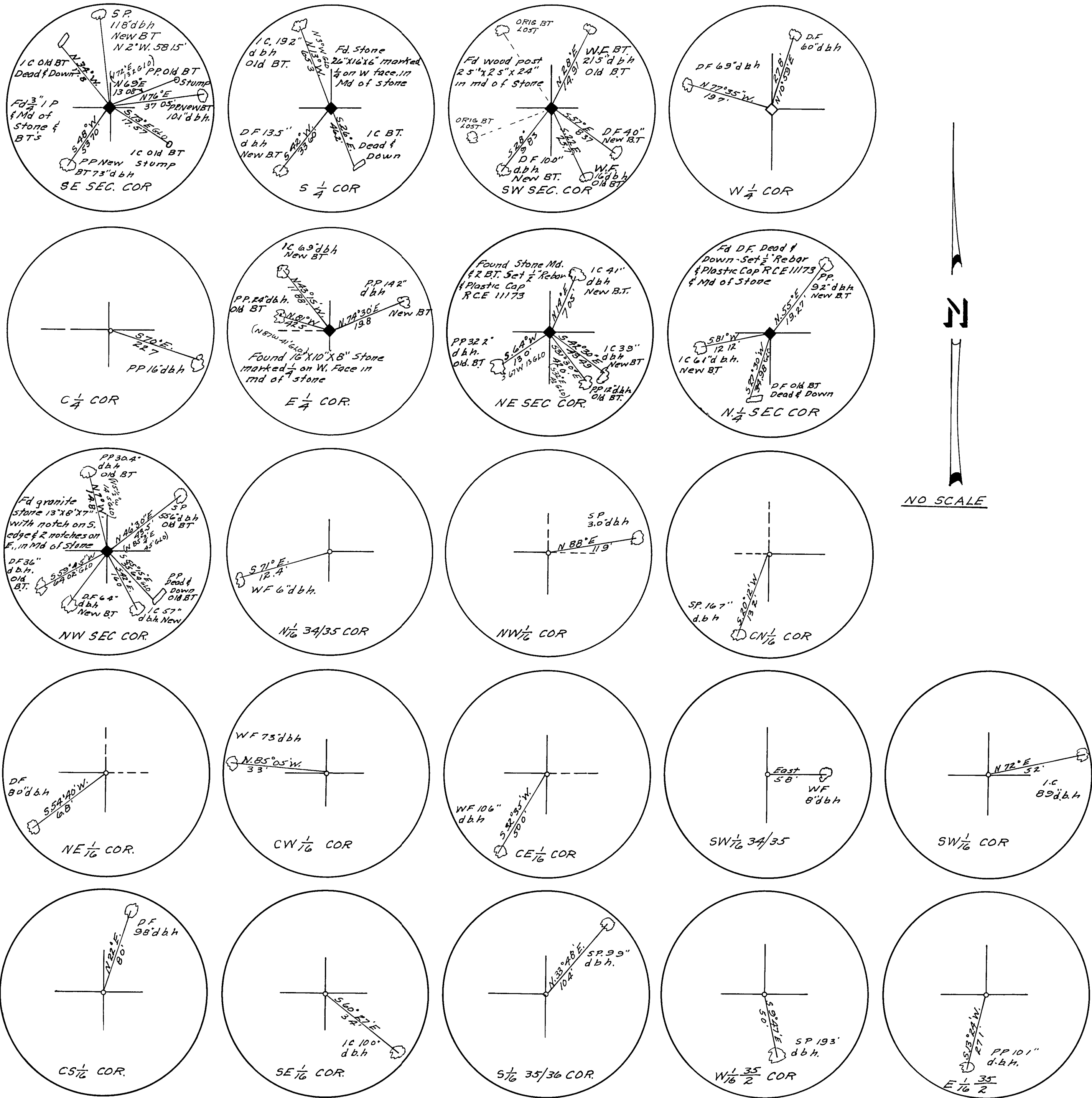
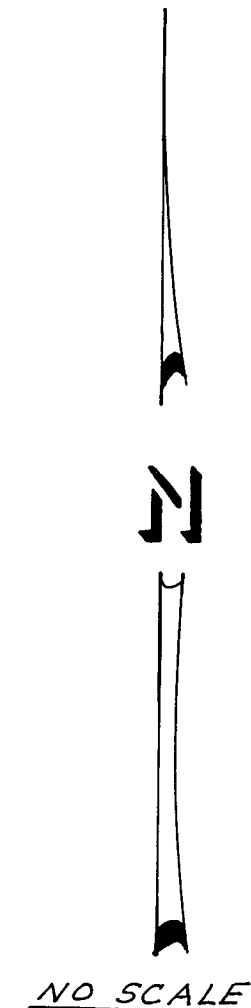

RECORD OF SURVEY
SEC 35, T23N, R11 E, M. DM.