

TOTAL AREA 5.35 Acre
 SETBACK AREA 0.03 Acre
 LAND AREA 5.32 Acre

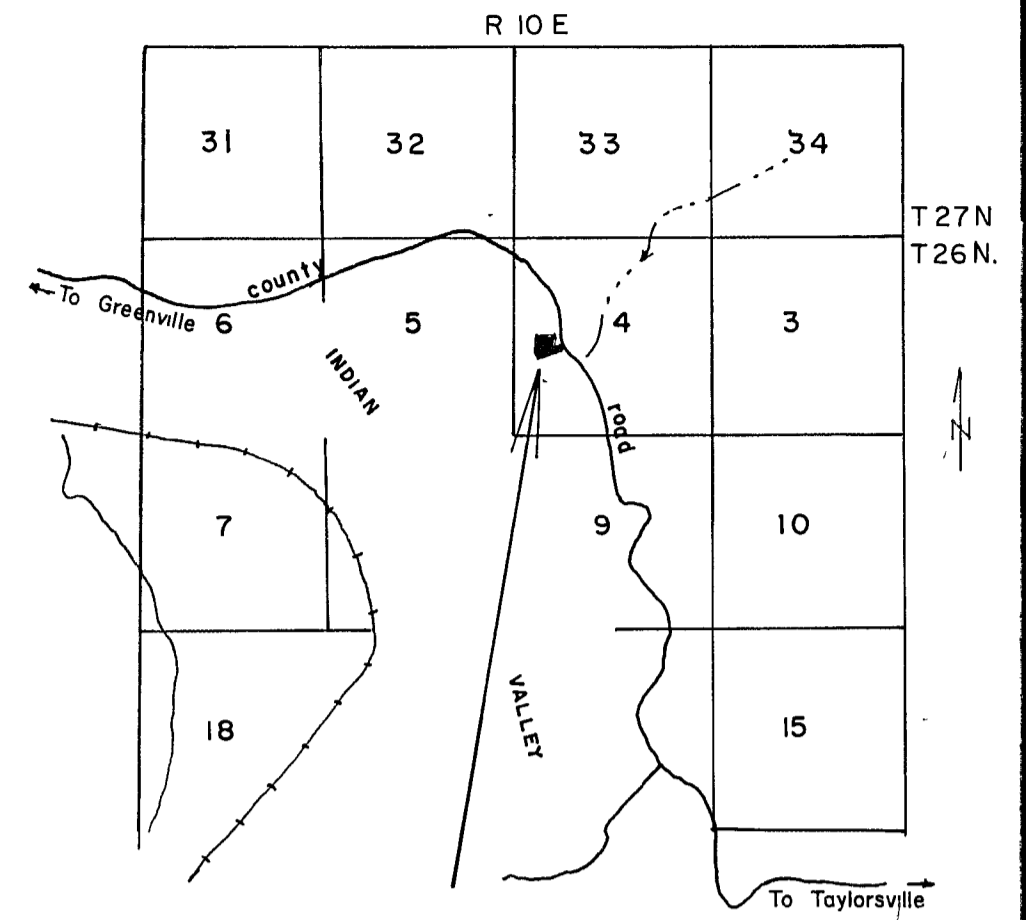

LOCATION MAP
 SCALE 1" = 1 mile

SURVEYOR'S CERTIFICATE

This map correctly represents a survey made by me or under my direction in conformance with the requirements of the Land Surveyor's Act at the request of Don Dunham in August 1977. This Record of Survey does not constitute a subdivision under Division 2 of Title 7, of Government Code

Mack O. Scruggs
 Mack O Scruggs L.S. 2357

COUNTY SURVEYOR'S CERTIFICATE

This map has been examined for conformance with the requirements of the Land Surveyor's Act this 15th day of June, 1978

Larry D. Fife
 Plumas County Surveyor

RECORDER'S CERTIFICATE

Filed this 15th day of June, 1978, at 2:00 A.M. in Book 5 of Record of Surveys, at page 21, at the request of Mack O Scruggs

Raynelle Slaten
 County Recorder

Fee \$ 5.00
 File No 9071

By *Catherine Shuman*
 Deputy

LEGEND

- SET 1/2"X18" IP TAGGED L.S. 2357
- FOUND MONUMENT AS NOTED
- CALCULATED CORNER
- EDGE OF PAVEMENT SECTION CORNER
- CHS. CHAINS
- FND FOUND
- IP IRON PIPE
- MEAS MEASURED
- REC RECORD
- SLS SWAMP & OVERFLOW LAND SURVEY

Mack O Scruggs
 438 Main Street
 Greenville, Calif.
 L.S. 2357

RECORD OF SURVEY

A PORTION OF THE NW 1/4 OF SW 1/4 OF SECTION 4, T.26N., R.10E., M.D.B. & M. PLUMAS COUNTY, CALIFORNIA

SURVEYED AT THE REQUEST OF DON DUNHAM

SCALE 1" = 50' AUGUST 1977