

**COURSE DATA**

(A)	S 89° 58' 11" E - 130.31	(N 89° 52' 02" E - 130.91 E)
(B)	N 89° 56' 52" E - 199.71	
(C)	N 89° 58' 04" E - 199.76	
(D)	N 80° 43' 59" E - 200.10	N 89° 52' 02" E - 200.00
(E)	N 89° 49' 58" E - 199.46	
(F)	N 89° 47' 15" E - 199.96	

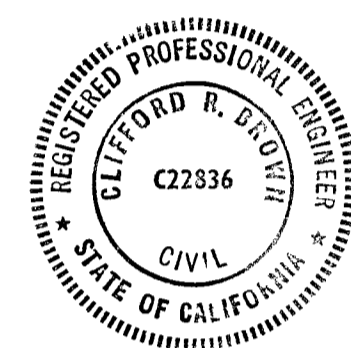

- LEGEND**
- FOUND MONUMENT AS NOTED
  - FOUND 1" I. PIPE, R.C.E. 11173
  - ⊕ FOUND 3/4" I. PIPE, R.C.E. 292
  - ⊗ FOUND 1 1/2" I. PIPE
  - ⊙ FOUND 1/2" I. ROD, R.C.E. 11173
  - ⊛ FOUND 8" x 8" WOOD POST
  - ⊞ SEE COURSE DATA
  - EXTENDED LINES OF SURVEY
  - BOUNDARY SURVEYED
  - SET 1/2" x 18" I. ROD, R.C.E. 22836

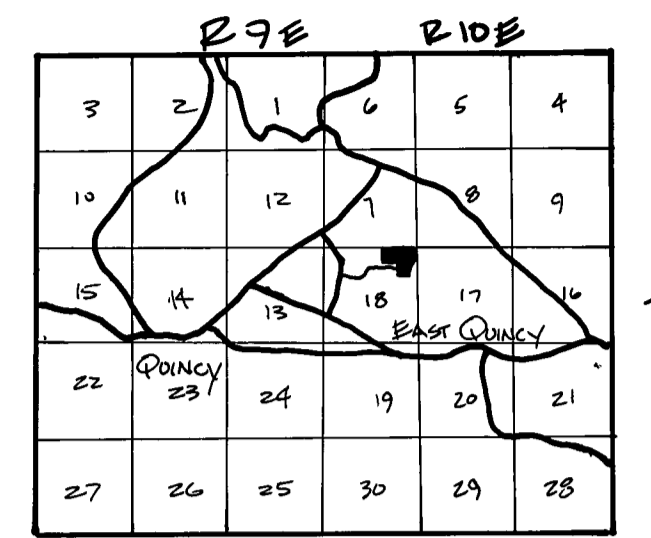

**SURVEYOR'S CERTIFICATE**

THIS MAP CORRECTLY REPRESENTS A SURVEY MADE BY ME OR UNDER MY DIRECTION IN CONFORMANCE WITH THE REQUIREMENTS OF THE LAND SURVEYOR'S ACT AT THE REQUEST OF LARRY LARSSON IN JULY, 1979.

Clifford R. Brown  
 CLIFFORD R. BROWN  
 R.C.E. 22836

**COUNTY SURVEYOR'S CERTIFICATE**

THIS MAP HAS BEEN EXAMINED FOR CONFORMANCE WITH THE REQUIREMENTS OF THE LAND SURVEYOR'S ACT THIS 25<sup>TH</sup> DAY OF JANUARY, 1980.

Lawrence J. Brock  
 by: R. Tom Linton R.C.E. 30515  
 LAWRENCE J. BROCK R.C.E. 13528  
 PLUMAS COUNTY SURVEYOR

NOTES: 1) SECTION CORNER 18/17 SET BY DOUBLE PROPORTION 19/20 AS PER B.L.M. MANUAL OF SURVEYS NO BEARING TREES WITHIN REASONABLE DISTANCE.

**RECORD OF SURVEY**

FOR: **LARRY LARSSON**

LOCATED IN THE NE QUARTER SECTION 18, T24N, R10E, M.D.M., PLUMAS COUNTY, CALIFORNIA

DATED: JANUARY 4, 1980

**COUNTY RECORDER'S CERTIFICATE**

FILED THIS 25<sup>TH</sup> DAY OF JANUARY, 1980 AT 1:03 P.M. IN BOOK 5 OF RECORD OF SURVEYS, AT PAGE 91, AT THE REQUEST OF THE COUNTY ENGINEER

FEE \$ 5.00  
 FILE NO. 8370

Ila Diggs  
 COUNTY RECORDER  
 By: Isabelle Anderson  
 DEPUTY