

Middle Fork of the Feather River

- LEGEND**
- Found Point as noted
  - Set Rebar #1 Plastic Cap LS 2843
  - R Record
  - M Measured
  - C Calculated
  - ④ Block Number
  - Set Nail # Tag LS 2843

Note: Lot Line Adjustment recorded in Book 324 of Official Records at Page 599, Plumas County Records.

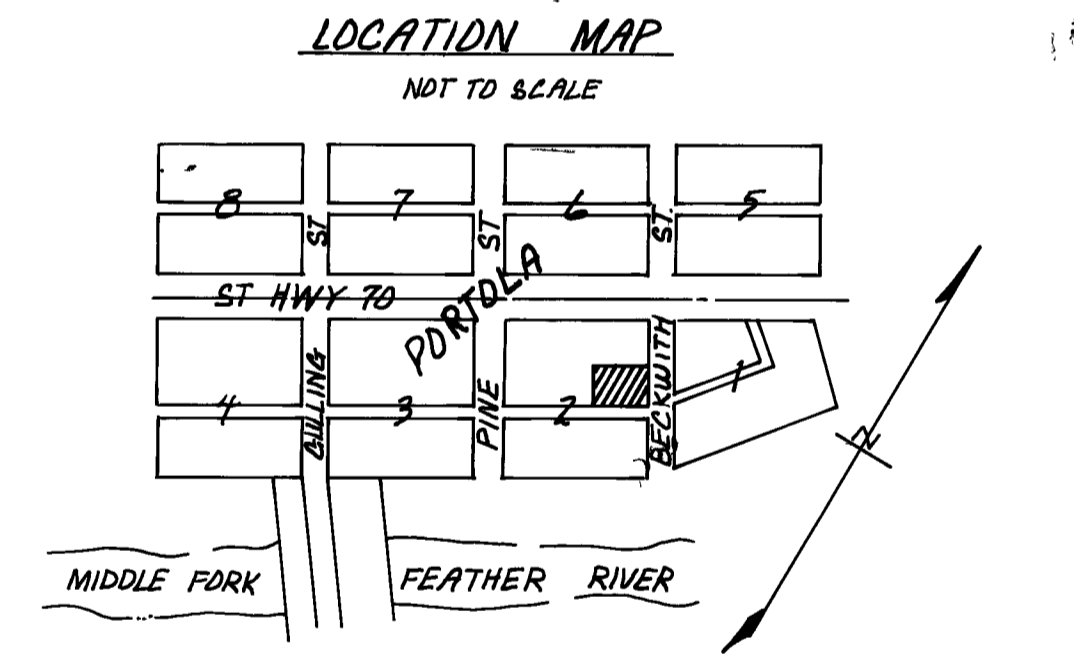

RECORD OF SURVEY  
for  
**ERNEST ROSS, ETAL**  
Being a Portion of Block 2, Portola Townsite,  
Section 36, T.23N, R.13E, M.D.B. & M.  
Plumas County, California  
January 1980

**SURVEYOR'S CERTIFICATE**  
This map correctly represents a survey made by me or under my direction in conformance with the requirements of the Land Act at the request of Ernest Ross, 1980.

*John W. Hamby*  
John W. Hamby LS 2843

**COUNTY SURVEYOR'S CERTIFICATE**  
This map has been examined for conformance with the requirements of the Land Surveyors Act this 31<sup>st</sup> day of March, 1980.

*Lawrence J. Brock*  
Lawrence J. Brock RCE 13528  
Plumas County Surveyor

**RECORDERS CERTIFICATE**  
Filed this 31<sup>st</sup> day of March, 1980, at 2:35 P.M. in Book 5 of Records of Survey at Page 223 at the request of the County Engineer.

Fee \$ 5.00  
File No. 7915

Ila Diggs  
County Recorder

By *Frances Nicol*  
Deputy

JOHN W. HAMBY  
Paradise, California  
P.O. Box H.H.  
(916) 877-6253

LICENSED LAND SURVEYOR  
Portola, California  
P.O. Box 842  
(916) 832-5571

BRUNING 44-132 40883

80003