

U. S. A.

BASIS OF BEARINGS:

Bearings shown hereon are based on the bearing N0°07'42"E between the monuments found at the Northeast corner of Section 10 and the East 1/4 corner of the N.E. 1/4 of Sec. 10. Both corners and the bearing between are shown on map recorded in Bk. 4 R.S. pg. 147, Official Records of Plumas County, California.

J. W. SMITH ET UX - 269 O.R. 350

J. SMITH ET UX - 269 O.R. 350

ORCUTT - 282 O.R. 350

U.S.A.

U.S.G.L.O. 588° 58' 30" E (40.06 Chs.) 2699.61'

U.S.G.L.O. 588° 55' 43" E (40.06 Chs.) 2601.55'

2024.71'

674.90'

Fnd. 15" dia. Pine in remains of stone mound. Piece of cedar post lying nearby. 20" nail driven in North side of tree base, which nail was used as corner. New U.S.F.S. poster nailed on tree dated 1979.

Fnd. stone 30"x15"x12" with chiseled marks at base on West side (Original dimensions stated as 30"x12"x10") fnd. 1/2" φ steel pin (No tag) set in center of North side. Attached L.S. 2712 tag and used as 1/4 corner. Stone located along North side of marshy spring area.

Fnd. hewn cedar post (approx. 3"x3"x36") scribed "2-3-10-11", in stone mound. Replaced with 1 1/2" O.D. iron pipe with plug tagged L.S. 2712 (30" long & driven into ground 28")

Fnd. 1/2" φ Steel Pin with plastic top marked "L.S. 3297"

Set 1 1/2" O.D. Iron Pipe & tag L.S. 2712 at NW cor. NE 1/4, N.E. 1/4, N.W. 1/4, Section 10

J.W. & E.M. SMITH
269 O.R. 350

J. W. SMITH ET UX - 269 O.R. 350

N89°55'03"W 2639.44' per 4 R.S. 147 (Not Surveyed)

Fnd. 1/2" φ Steel Pin & plastic top "L.S. 3297" per 4 R.S. 147.

South line of N.W. 1/4 of Section 11 per 4 R.S. 147 (Not surveyed.)

S89°48'30"E 2640.09'

Existing fence line and present line of occupation.

Fnd. Brass Mon. stamped "29c + 53.46 E.C." per 4 R.S. 147 (Not Surveyed)

N0°14'00"E 1219.18'

A: 4° 20' 48"
R: 1050.31'
L: 179.68'

Per 4 R.S. 147 (Not surveyed)

File No 801632 C750

SCALE: 1" = 400'

ORCUTT - 282 O.R. 704

Fnd. Stone 15"x11"x7 1/2" in stone mound with piece of burned fence post. Stone not marked. Original stone described as 15"x10"x8"; 2 U.S.F.S. K Tags & 2 Nat. Forest posters on post. Set 1 1/2" O.D. Iron pipe (30" long) with tag "L.S. 2712"

Fnd. 1/2" φ Steel Pin with plastic top "L.S. 3297" per 4 R.S. 147

E-W Centerline - Section 10
N89°19'01"W 5327.46'

M'PHERRIN - 274 O.R. 222

ORCUTT - 282 O.R. 704

SURVEYOR'S CERTIFICATE:

This map correctly represents a survey made or under my direction in conformance with the requirements of the Land Surveyors Act at the request of Jim Smith in April 1980.

William W. Grimm
William W. Grimm, L.S. 2712

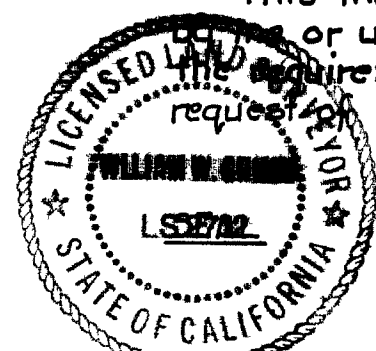

COUNTY SURVEYOR'S CERTIFICATE:

This map has been examined for conformance with the requirements of the Land Surveyors Act this 22nd day of July, 1980

Lawrence J. Brock R.C.E. 13528
Plumas County Surveyor

RECORDER'S CERTIFICATE:

Filed this 22nd day of July, 1980 at 1:15 PM in Book 5 of Records of Surveys at page 122 at the request of the County Engineer

Fee: \$ 5.00
Instr. No 533
Ila Diggs, County Recorder
By: Frances Nicol, Deputy

LEGEND:

- 3/2 indicates Section Corner as noted.
- 10/11 indicates 1/4 Corner as noted.
- 8/9 indicates 1/4 Corner as noted.
- indicates 1/4 or 1/64 Corner as noted.
- indicates other corner as noted.

Note: Data shown concerning the N.W. 1/4 of Section 11 above, is record data from 4 R.S. 147. Its purpose is to define the location of the fence line and line of occupation this date.

Fnd. 1/2" φ Steel pin with plastic top "L.S. 3297" at intersection of fence lines bearing Southeast-West & 15° North. Pin sits on 2/3 of intersection.

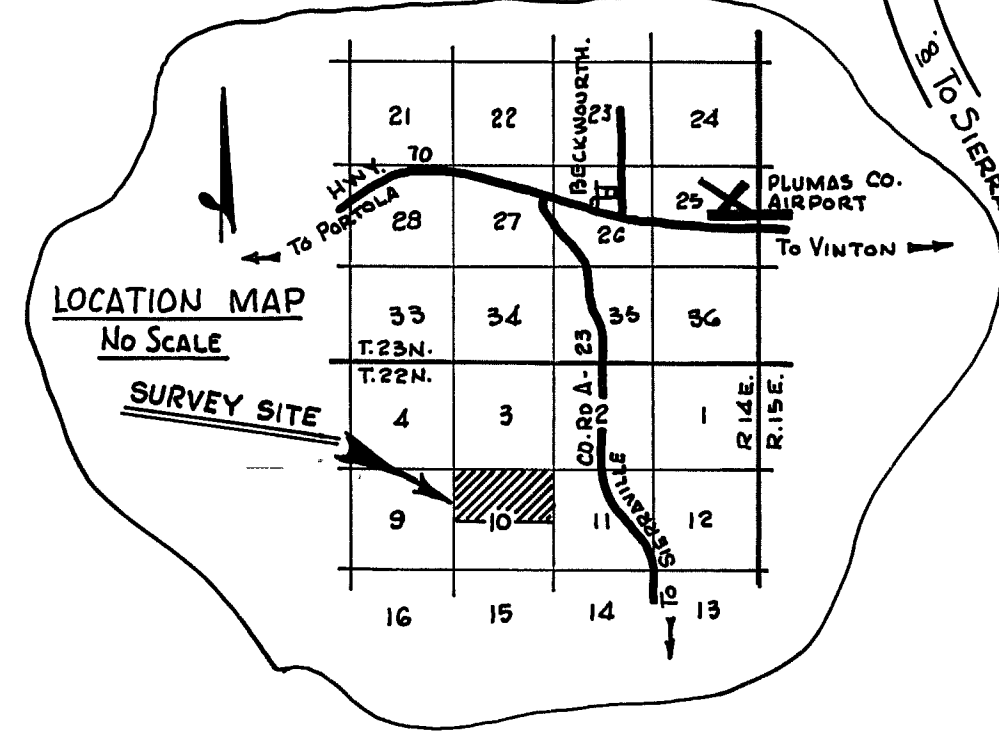

PREPARED FOR: J.W. & E.M. SMITH.
A RECORD OF SURVEY MAP OF THE NORTH 1/2, SECTION 10, T.22N., R.14E., M.D.M., PLUMAS COUNTY, CALIFORNIA

SCALE: 1" = 400' APRIL 1980
WILLIAM W. GRIMM, L.S. 2712
P.O. BOX 1105
TAHOE CITY, CALIFORNIA 95730

ONE SHEET ONLY