

COUNTY SURVEYOR'S CERTIFICATE

THIS MAP HAS BEEN EXAMINED FOR CONFORMANCE WITH THE REQUIREMENTS OF THE LAND SURVEYORS

ACT THIS 18<sup>th</sup> DAY OF September, 1981

Lawrence J. Brock  
LAWRENCE J. BROCK R.C.E. 13528  
PLUMAS COUNTY SURVEYOR

BASIS OF BEARING NOTE

THE BASIS OF BEARING FOR THIS SURVEY ARE BASED ON THE EAST LINE OF SECTION 9, T25N, R9E, M.D.M. SHOWN HEREON AS N00°04'31"W AS DETERMINED BY THE OBSERVATION OF THE SUN.

AND

THE NORTH-SOUTH MIDSECTION LINE OF SECTION 29, T26N, R9E, M.D.M. SHOWN HEREON AS N00°39'28"W AS DETERMINED BY OBSERVATION OF THE SUN.

AND

THE SOUTH LINE OF SECTION 6, T25N, R9E, M.D.M. SHOWN HEREON AS N85°02'20"E AS DETERMINED BY OBSERVATION OF THE SUN.

COUNTY RECORDER'S CERTIFICATE

FILED THIS 18<sup>th</sup> DAY OF September, 1981

AT 10:20 A.M., IN BOOK 6 OF Record of Surveys,

AT PAGE 25, AT THE REQUEST OF the County Engineer

ILA D1665  
PLUMAS COUNTY RECORDER

FEE \$17.00

BY Isabelle Andrews  
DEPUTY

FILE NO. 2753

SURVEYOR'S CERTIFICATE

THIS MAP CORRECTLY REPRESENTS A SURVEY MADE BY ME OR UNDER MY DIRECTION IN CONFORMANCE WITH THE REQUIREMENTS OF THE LAND SURVEYORS ACT AT THE REQUEST OF U.S. FOREST SERVICE IN SEPTEMBER, 1979

SIGNED Norman Payne  
L.S. NO. 4388

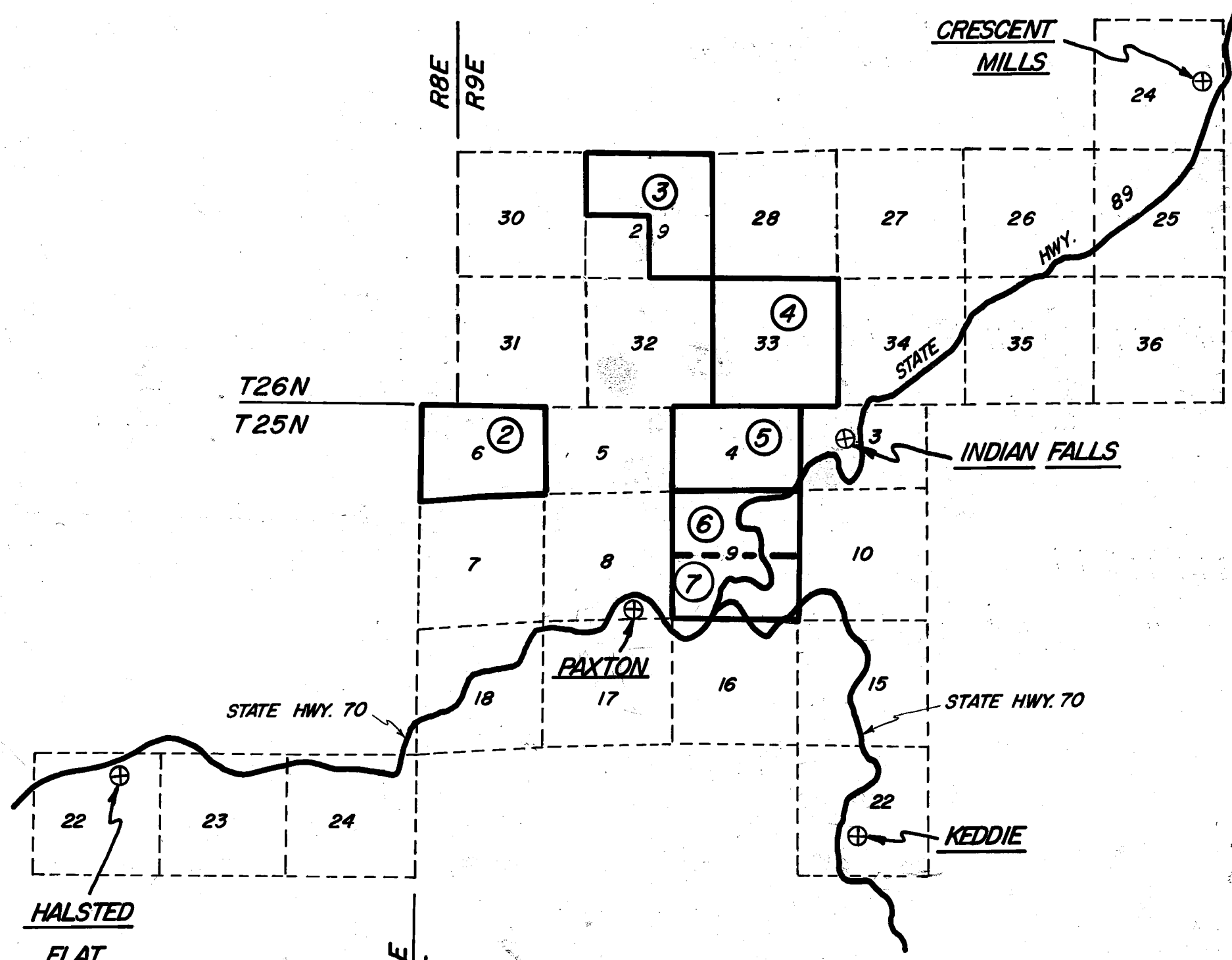

INDEX TO SHEETS  
AND  
VICINITY MAP  
(NO SCALE)

RECORD OF SURVEY

FOR

UNITED STATES FOREST SERVICE  
PLUMAS NATIONAL FOREST

IN SEC. 29 AND 33, T26N, R9E, AND SEC. 4, 6, AND 9,  
T25N, R9E, M.D.M.

PAYNE SURVEYING  
2946 INEZ STREET  
REDDING, CA. 96001  
PHONE 916-243-1730  
DATE OCTOBER 1979 SHEET 1 OF 7