

LEGEND

- Found monuments as noted.
 - Set 1/2" iron pipe tagged "L.S. 4647."
 - () Indicates record per R/S 2-56 (except as noted)
- Ties from corners that were set:

- ① 5.56' 19"E 6.24' 3/4" i.p. R.C.E. 7567 per R/S 1-145; 5.41' 46"E 6.40' 2"x2" hub R.C.E. 5895 per P/M 8-76.
- ② N84°W 0.19' P.G.E. Pin #1225; 5.40' 56"E 6.38' 2"x2" hub R.C.E. 5895 per P/M 8-76.
- ③ 5.44' 36"E 6.59' 2"x2" hub R.C.E. 5895 per P/M 8-76.
- ④ 5.16' 45"E 5.65' P.G.E. Pin #1222; 5.49' 26"E 7.06' 2"x2" hub R.C.E. 5895 per P/M 8-76.
- ⑤ 5.51' 53"E 7.39' 2"x2" hub R.C.E. 5895 per P/M 8-76.
- ⑥ N8°53'E 2.74' P.G.E. Pin #1220; 5.59' 44"E 8.04' 2"x2" hub R.C.E. 5895 per P/M 8-76.
- ⑦ N83°W 1.65' P.G.E. Pin #1219; 5.56'E 7.30' 2"x2" hub R.C.E. 5895 per P/M 8-76.
- ⑧ 5.58' 39'E 4.67' P.G.E. Pin #1218A; 5.61'E 7.45' 2"x2" hub R.C.E. 5895 per P/M 8-76.
- ⑨ 5.64'E 7.10' 2"x2" hub R.C.E. 5895 per P/M 8-76.
- ⑩ 5.68' 54'E 6.98' 2"x2" hub R.C.E. 5895 per P/M 8-76.
- ⑪ N21°45'E 1.19' P.G.E. Pin #1216; 5.69' 41'E 6.78' 2"x2" hub R.C.E. 5895 per P/M 8-76.
- ⑫ 5.70' 44'E 6.21' 3/4" i.p. L.S. 2587 & R.C.E. 7567 per R/S 1-37 & R/S 1-145 (See Note No 1); 5.56' 37'E 19.38' 3/4" i.p. R.C.E. 7567 per R/S 1-145; 5.75' 30'E 28.40' P.G.E. Pin (no #).
- ⑬ 5.65' 32'E 6.23' 3/4" i.p. R.C.E. 7567.
- ⑭ 5.56' 23'E 6.39' 2"x2" hub R.C.E. 5895 P/M 8-76.

NOTES:

- The Ecker corner found by Vandenberg had obviously been set between 1950 & 1957 as evidenced by other found corners; therefore the Vandenberg survey (R/S 1-145) erroneously located the property approx. 6 feet S.E. 1/4.
- Calc. tie to 3/4" i.p. tagged "L.S. 2322" for 1/4 Cor per R/S 6-55 is N11°45'28"E 1051.53'. Deed tie and tie on R/S 1-37 is N11°56'55"W 1028.07'. Apparently R/S 1-37 used location for 1/4 Cor. ± 20' N.E. 1/4 from true corner.

SURVEYOR'S CERTIFICATE:

This map correctly represents a survey made by me in conformance with the requirements of the Land Surveyor's Act at the request of Owen Templeton, L.S. 4647, dated 1982.

Vernon H. Templeton
Vernon H. Templeton, L.S. 4647

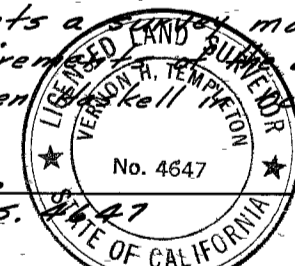

COUNTY SURVEYOR'S CERTIFICATE:

This map has been examined for conformance with the requirements of the Land Surveyor's Act this 13th day of DECEMBER, 1982.

Lawrence J. Brock
Lawrence J. Brock, Plumas Co. Surveyor, R.C.E. 13528

COUNTY RECORDER'S CERTIFICATE:

Filed this 16th day of December, 1982 at 3:20 A.M. in Book 6 of Record of Surveys at page 87, at the request of the County Engineer. Fee: \$ 5.00 File No. 4495
Ila Diggs, Plumas County Recorder

by: Lawrence Brock
Deputy

**RECORD OF SURVEY FOR
ALMANOR LAKESIDE VILLAS, INC.**

IN SECTION 10, T.27N., R.8E., M. D. B. & M.
PLUMAS COUNTY, CALIFORNIA

SCALE: 1" = 40'

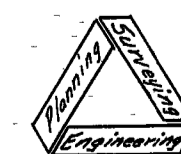

NST Engineering Associates, Inc.
45 South Roop Street
Susanville, California
916-257-5173

Sheet 1 of 1