

SCALE: 1" = 1000'  
MAG. DEC. 18° 30'

BASIS OF BEARINGS: SOLAR  
OBSERVATION AT S.E. COR. OF  
SEC. 10. LATITUDE: N 40° 23' 00"  
SUN: S 80° 40' 16" W JULY 4, 1983  
AT 3:15 P.M. P.D.T.

③ WITNESS CORNER N 89° 57' 17" E, 511.00' FROM  
S 1/16 COR. SEC. 10, SET 1/2" REBAR WITH  
1/2" ALUM. CAP MARKED LS 4894. (1/16 COR.  
FALLS IN LAKE.)  
④ E 1/16 COR. 10/15 CALCULATED COR., ONLY.

- MARKED & POSTED LINE
- CORNER SET ( ) PER 6 RS 50
- CORNER FD. [ ] PER G.L.O.
- METER = 3.28 FEET
- I.R.M. = IN ROCK MOUND

ORIGINAL SURVEY T.29N., R.4E., S10

THE ORIGINAL SURVEY WAS IN 1866 BY J.M. INGALLS FOLLOWED BY W.H. CARLTON IN 1870, G. SANDOW IN 1882, AND V.S. BARBER IN 1903. IN OCT. 1981 GRIFFITH & ASSOC. DID A SURVEY ALONG THE BOUNDARIES OF THE S.E. 1/4 OF S10, AND FILED A MAP IN PLUMAS COUNTY IN BOOK 6 RECORD OF SURVEYS PG.50. IN JULY 1981 UPTEGROVE ENGINEERING DID A SURVEY USING THE S.W. COR. S10, AND FILED A MAP IN PLUMAS COUNTY BOOK 6 RECORD OF SURVEYS PG. 19. IN DEC. 1976 J.L. UPTEGROVE DID A SURVEY USING THE N.W. COR. S10 AND FILED A MAP IN PLUMAS COUNTY BOOK 4 OF RECORD OF SURVEYS PG.112

① 1/4 9 | 10 FD. 2" IRON PIPE W/3 1/2" BRASS CAP I.R.M.  
U.S.F.S. MON. MKD. T. 29 N., R.6 E. 1/4 S9 | S10  
FD. B.T.'S  
18" FIR N45°E, 40.5 LKS. S10 W/BLAZE  
33" FIR S15°E, 62.0 LKS. S10 NO BLAZE  
27" FIR S20°W, 66.0 LKS. S9 BLAZE W/SCRIBING (ORIG.)

② 1/4 10 | 15 FD. 2 1/2" IRON PIPE W/3 1/2" BRASS CAP PER 6 RS 50,  
B.L.M. MON. MKD. T. 29 N., R.6 E. 1/4 S10 | S15 1973  
FD. B.T.'S  
14" LODGEPOLE PINE N20°W, 44 LKS. S10 BLAZE W/SCRIBING (ORIG.)  
22" PINE N36°W, 52 LKS. S10 W/BLAZE  
12" DOWN SNAG S46°W, 20 LKS. SCRIBING S15 S1/4 B.T. (ORIG.)  
12" LODGEPOLE PINE S32°E, 14 LKS. S15 BLAZE W/SCRIBING

⑤ 1/4 COR. 3/10 SET 2" IRON PIPE W/3 1/2" BRASS CAP I.R.M.  
MKD. T.29N., R.6E 1/4 S3 | S10 LS 4894 1983  
NEW B.T.'S  
11" FIR S66°E, 74.0' SCRIBED S1/4 S3 B.T.  
15" FIR N78°W, 36.0' SCRIBED N1/4 S10 B.T.

⑥ SE 1/16 SET 1/2" REBAR W/1 1/2" ALUM. CAP I.R.M.  
MKD. SE 1/16 L.S.4894  
NEW B.T.'S  
8" LODGEPOLE PINE S2°W, 9.9' SCRIBED SE 1/16 S10 B.T.  
11" LODGEPOLE PINE N24°E, 3.6' SCRIBED SE 1/16 S10 B.T.

⑦ E 1/16 SET 1/2" REBAR W/1 1/2" ALUM. CAP I.R.M.  
MKD. E 1/16 L.S.4894  
NEW B.T.'S  
9" LODGEPOLE PINE N81°E, 24.0' SCRIBED E 1/16 S10 B.T.  
13" LODGEPOLE PINE S65°E, 43.6' SCRIBED E 1/16 S10 B.T.

⑧ 10 | 11 | 15 | 14 FD. 2 1/2" IRON PIPE W/3 1/2" BRASS CAP I.R.M. PER 6 RS 50,  
B.L.M. MON. MKD. T.29N., R.6E. 10 | 11 | 15 | 14 1974  
W/1/2" PIPE ALONGSIDE R.C.E. 7567  
FD. B.T.'S  
14" TAMARACK S57°W, 46.5 LKS. S15 W/BLAZE  
15" CEDAR S29°E, 34 LKS. S14 SCRIBED T.29N., R.6E. S14 B.T.  
18" TAMARACK SNAG N68°E, 11 LKS. S15 BLAZE W/SCRIBING  
16" DOWNED SNAG S55°E, 19.0 LKS. S14 W/SCRIBING  
15" TAMARACK N87°30'E, 69 LKS. S11 W/BLAZE

⑨ S1/16 S10 | S11 FD. 5/8" REBAR W/2" ALUM. CAP I.R.M., PER 6 RS 50,  
MKD. S16 10 | 11 L.S. 3318  
FD. B.T.'S  
9" CEDAR N89°E, 11.8' SCRIBED S1/16 S11 B.T.  
11" TAMARACK S32°E, 20.0' SCRIBED S1/16 S11 B.T.

⑩ 1/4 10 | 11 FD. 2" IRON PIPE W/3 1/2" BRASS CAP I.R.M., PER 6 RS 50,  
U.S.F.S. MON. MKD. T.29N., R.6E. 1/4 S10 | 11 L.S. 3318  
FD. B.T.'S  
17" CEDAR N51°E, 47.5' SCRIBED 1/4 S11 B.T.  
22" PINE N87°30'W, 51.5' S10 BLAZE W/SCRIBING

⑪ 3 | 2 | 10 | 11 FD. 2 1/2" IRON PIPE W/3 1/2" BRASS CAP I.R.M., PER 6 RS 50,  
B.L.M. MON. MKD. T.29N., R.6E. 3 | 2 | 10 | 11 1973  
FD. B.T.'S  
7" FIR N48°W, 24 LKS. SCRIBED T. 29N., R.6E. S3 B.T.  
18" CEDAR SNAG S81°30'W, 60 LKS. S10 BLAZE W/SCRIBING  
21" PINE N20°E, 32.0 LKS. S2  
12" CEDAR N.55°E, 52 LKS. SCRIBED T.29N., R.6E. S2 B.T.  
21" DOWN SNAG S51°E, 71 LKS. S11 BLAZE  
13" FIR S39°30'E, 95 LKS. S11 BLAZE W/SCRIBING  
7" CEDAR S21°W, 43 LKS. SCRIBING T.29N., R.6E. S10 B.T.

⑫ 4 | 3 | 9 | 10 FD. 2" IRON PIPE W/3 1/2" BRASS CAP I.R.M.  
U.S.F.S. MON. MKD. T. 29 N., R.6 E. SEC. COR. S4 | S3 | S9 | S10 R.C.E. 22148 1976  
FD. B.T.'S  
15" Y. PINE N19°E, 26.4' SCRIBED T29N, R6E, S3, BT  
10" FIR S44°30'E, 14.2' SCRIBED T29N, R6E, S10, BT  
7" CEDAR S48°W, 3.8' SCRIBED T29N, R6E, S9, BT  
15" Y. PINE N50°W, 21.0' SCRIBED T29N, R6E, S4, BT

**SURVEYOR'S CERTIFICATE**  
THIS MAP CORRECTLY REPRESENTS A SURVEY  
MADE BY ME OR UNDER MY DIRECTION IN CONFORMANCE  
WITH THE REQUIREMENTS OF THE LAND SURVEYORS ACT  
AT THE REQUEST OF THE PLUMAS COUNTY SUPERVISORS FOR THE LASSEN NATIONAL FOREST IN JULY, 1983.



COUNTY SURVEYOR'S CERTIFICATE  
THIS MAP HAS BEEN EXAMINED FOR CONFORMANCE  
WITH THE REQUIREMENTS OF THE LAND SURVEYOR'S  
ACT THIS 20 DAY OF October, 1983  
Lawrence J. Brock  
LAWRENCE J. BROCK R.C.E. 13528  
PLUMAS COUNTY SURVEYOR

COUNTY RECORDER'S CERTIFICATE  
FILED THIS 30 DAY OF October, 1983,  
AT 11:00 A.M. IN BOOK 6 OF RECORD OF SURVEYS  
AT PAGE 105 AT THE REQUEST OF THE COUNTY  
ENGINEER ILA DIGGS  
FEE \$ 500 COUNTY RECORDER  
FILE NO. 3566 BY Patricia Lacey  
DEPUTY  
VICINITY MAP

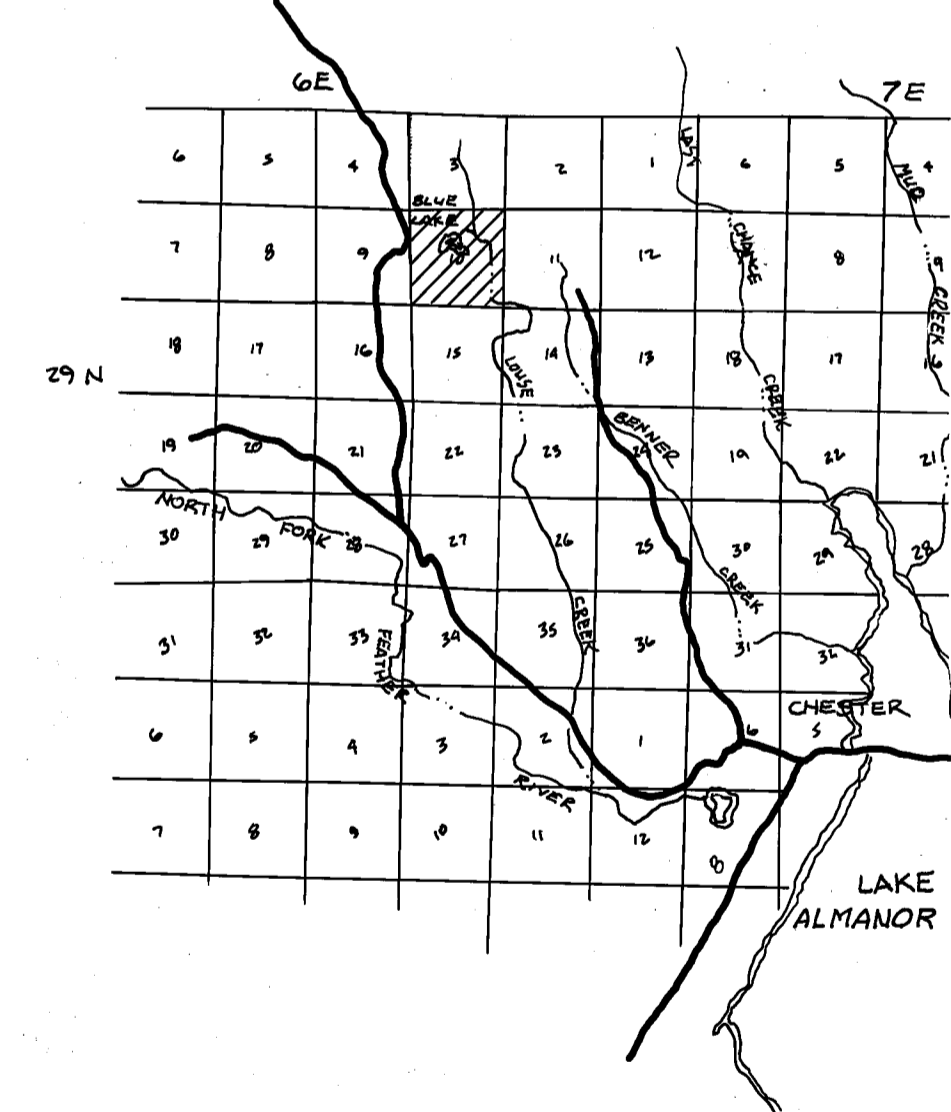

RECORD OF SURVEY  
IN THE  
UNINCORPORATED TERRITORY OF PLUMAS  
COUNTY, CALIFORNIA, BEING A PORTION OF  
SECTION 10, T.29N., R.6E., M.D.M.  
FOR  
**LASSEN NATIONAL FOREST**  
BY: NORTH VALLEY SURVEYORS REDDING, CALIF.  
DATE: 7/23/83 SCALE: 1" = 1000' SHEET 1 OF 1