

LEGEND

- = SET USFS ALUM. MON. IN RM 1984 LS 4894
- ⊗ = FD. 3/4" PIPE W 2 1/2" CAP IN RM 1958 C.A.F. NO TAG, STAMPED LS 4894
- = FD. BLM MON. IN RM 2 1/2" PIPE W 3" BRASS CAP
- RM = ROCK MOUND
- (-) = RECORD PER GLO

NOTE: THE SOUTH HALF OF SECTION 7 IS DIVIDED PER BUREAU OF LAND MANAGEMENT INSTRUCTIONS ON MAY 29, 1984 AS FOLLOWS; EAST LINE OF SW 1/4 IS PARALLEL TO S 1/2 OF OF THE WEST LINE OF SEC. 7, NORTH LINE OF SW 1/4 IS PARALLEL TO THE W 1/2 OF THE SOUTH LINE OF SEC. 7, THE CENTER 1/4 CORNER FOR THE WEST 1/2 IS AT THE INTERSECTION OF THE ABOVE LINES, THE CENTER 1/4 CORNER FOR THE EAST 1/2 IS SET PROPORTIONALLY ALONG THE NORTH-SOUTH CENTER OF SECTION LINE

[] = RECORD PER 7 RS 27-29

— = LINE MARKED AND POSTED TO USFS STANDARDS

BEARING TREES

- ① 7/18 FD. 22" FIR N89W 33LKS H.B. BLM 48" PINE STUMP UPROOTED N77W 54LKS S. GLO 8" CEDAR S24W 59LKS S. BLM
- ② 7/8 FD. 48" PINE N45 1/2 W 32 1/2 LKS H.B. GLO 13" PINE N63E 146LKS H.B. BLM
- ③ 6/5 FD. 12" PINE S56W 40 1/2 LKS H.B. BLM 18" FIR N4W 113LKS S. BLM 11" PINE S60E 128 1/2 LKS H.B. BLM
- ④ E 1/16 SET: 24" FIR S40W 115' 9" PINE N50W 229'
- ⑤ 6/7 FD. 30" STUMP N31W 45LKS S. GLO 22" PINE S31E 74 1/2 LKS S. BLM 36" PINE N81E 144LKS H.B. BLM
- ⑥ 1/12 FD. 36" FIR S75W 80LKS H.B. GLO 24" FIR N17W 64LKS H.B. GLO
- ⑦ 6/7 cc. SET: 8" FIR S80E 273' 12" FIR N55E 292'
- ⑦A 6/7 FD. 8" SNAG N41-20E 47LKS S. GLO
- ⑧ 12/7 FD. 6" PINE DOWN EAST 37LKS S. GLO 11" PINE S48E 39LKS S. BLM
- ⑨ 12/7 FD. 30" FIR S76W 46LKS S. BLM 20" FIR N23W 120LKS S. BLM 26" FIR N53E 67LKS S. BLM 8" FIR N56E 33LKS H.B. BLM 36" FIR S76W 46LKS S. BLM
- ⑩ C 1/4 SET: 9" FIR S85W 335' W 1/2 12" PINE N5W 365'
- ⑫ C 1/4 SET: 6" FIR N78E 349' E 1/2 6" FIR S42E 509'
- ⑬ 7/18 FD. 26" PINE N48-10E 82 1/2 LKS H.B. GLO 18" PINE S19E 94LKS H.B. BLM 14" SNAG S43W 29LKS BLAZE BLM
- ⑭ E 1/16 SET: 8" PINE NORTH 284' S 7 19" PINE S26W 421'
- ⑮ 5/16 SET: 13" FIR S85E 292' 22" FIR N60W 105'
- ⑯ 6/5 FD. DOWN ROTTED SBIE 40LKS S. GLO 10" FIR S65E 31 1/2 LKS H.B. BLM 10" PINE S65W 30LKS H.B. BLM 14" SNAG S57W 83LKS S. GLO
- ⑰ 31/32 FD. 18" FIR N83E 69LKS H.B. BLM 7" PINE S54E 44LKS H.B. BLM 12" LODGEPOLE PINE S51-30W 42LKS S. BLM 34" FIR S65W 90LKS S. GLO 34" FIR N25W 127LKS H.B. BLM 36" STUMP N48W 60LKS H.B. GLO
- ⑱ 31/6 FD. 14" PINE N89E 59LKS S. BLM 12" LODGEPOLE PINE S10-30W 44LKS S. BLM 11" FIR S54-30W 55LKS H.B. BLM
- ⑳ 36/31 FD. 11" FIR S70E 7LKS S. GLO 13" PINE S10W 93LKS S. BLM
- ㉑ E 1/4 FD. 16" PINE N68E 27LKS S. BLM S 1 18" PINE S36W 53LKS S. BLM
- ㉒ W 1/4 SET: 9" PINE N85E 585' S 6 14" PINE S50E 335'
- ㉓ SE 1/16 SET: 15" FIR N70E 142' S 6 10" PINE SIDE 202'

H.B. = HEALED BLAZE
S. = LEGIBLE SCRIBING

Monuments set for this survey are marked per Manual of Instructions.

SURVEYORS STATEMENT

THIS MAP CORRECTLY REPRESENTS A SURVEY MADE BY ME OR UNDER MY DIRECTION IN CONFORMANCE WITH THE REQUIREMENTS OF THE LAND SURVEYORS ACT AT THE REQUEST OF LASSEN NATIONAL FOREST APRIL 1985

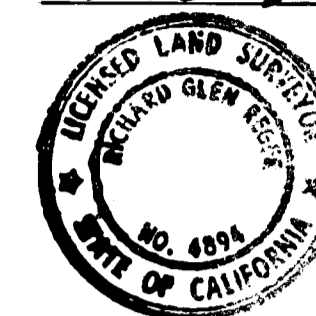

COUNTY SURVEYORS STATEMENT
THIS MAP HAS BEEN EXAMINED IN ACCORDANCE WITH SECTION 8766 OF THE LAND SURVEYORS ACT THIS 16TH DAY OF September 1985
(SIGNED) Lawrence J. Brock
PLUMAS COUNTY ENGINEER
LAWRENCE J. BROCK RCE 13528

RECORDERS CERTIFICATE

FILED THIS 16TH DAY OF September 19 85
AT 10:09 AM IN BOOK 7 OF R/S AT
PAGE 49 AT THE REQUEST OF
THE COUNTY ENGINEER

ILA DIGGS
COUNTY RECORDER
BY Richard J. Logan
DEPUTY
FEE \$5.00
FILE # 1812

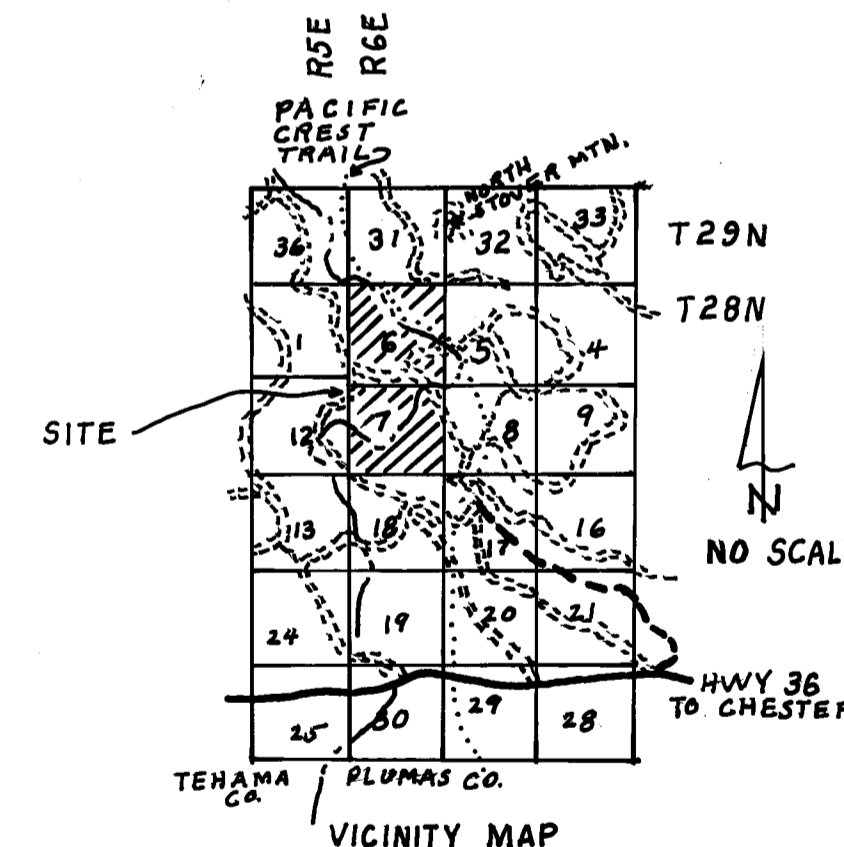

RECORD OF SURVEY

IN THE UNINCORPORATED TERRITORY OF
TEHAMA & PLUMAS COUNTIES
IN SECTIONS 6 & 7, T28N, R6E, M.D.M.
FOR: LASSEN NATIONAL FOREST
BY: NORTH VALLEY SURVEYORS
REDDING, CALIF.

APRIL 1985 SCALE 1"=1000'
SHEET 1 OF 1

