

PROJECT TEAM

This Cadastral Survey was accomplished by the pridelful efforts of:
 Jay Burgess L.S. - Bob Riggins Sr. Tech.
 R. Van Tessel Tech. Lance Sellers Tech.
 Ken Lewis Tech. John Riggins Tech.
 Jess Sandifer Tech.
 With Back up from:
 Bill Nowlin L.S. - R. Riggins Jr. LSIT
 Mark King LSIT
 and Judy (Bk) and Elsie B.

LEGEND

- Found Monument and accessories as described in Corner Notes on Sheet 2.
- Monument Set and marked LS 4790 per this Survey as noted in Corner Notes on Sheet 2.
- Monument marked R.C.E. 22836 and found as noted in "GENERAL NOTES", item 1.
- Dimension Line
- Property Boundary Marked and Posted per U.S.D.A. Class 'A' Specifications.
- ① Key to Corner Notes (Typical)

BASIS OF BEARINGS

Basis of Bearings by Solar Observation taken near the 1/4 corner between Sections 34 and 35, T.24 N., R.10E., M.D.M.

GENERAL NOTES

- 1.) This project, "Lee Summit Cadastral Survey," was accomplished for the Plumas National Forest as a reproduction of a previous Contract by the same name. For that reason Aluminum Caps and Pipes set by R.C.E. 22836 are not of record. Our work included Verifying R.C.E. 22836's corner positions and Property line as shown on his Survey Control Diagram and unrecorded plat obtained from the U.S. Forest Service in Quincy. This Record of Survey represents said Survey.
- 2.) Monuments not accepted by this survey are to be removed by others per the U.S.D.A. Forest Service.
- 3.) Questions pertaining to this survey should be directed to the U.S.D.A. Forest Service, Plumas National Forest, Quincy, California or Burgess Land Surveys, Redding, California.
- 4.) All closures on this survey exceed 1 in 5000 per USDA Forest Service Specifications.

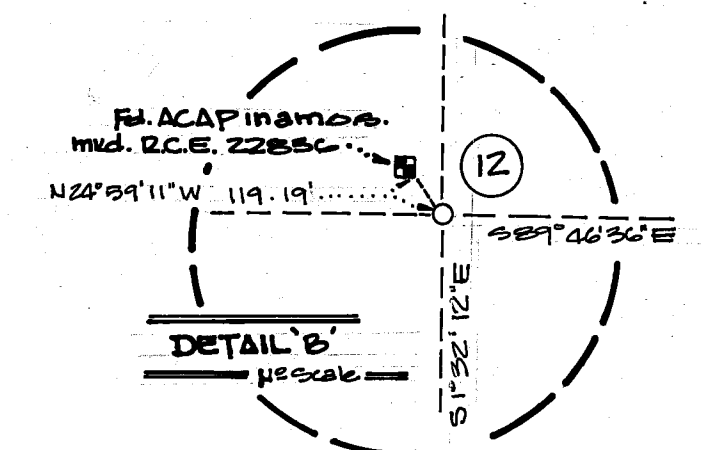
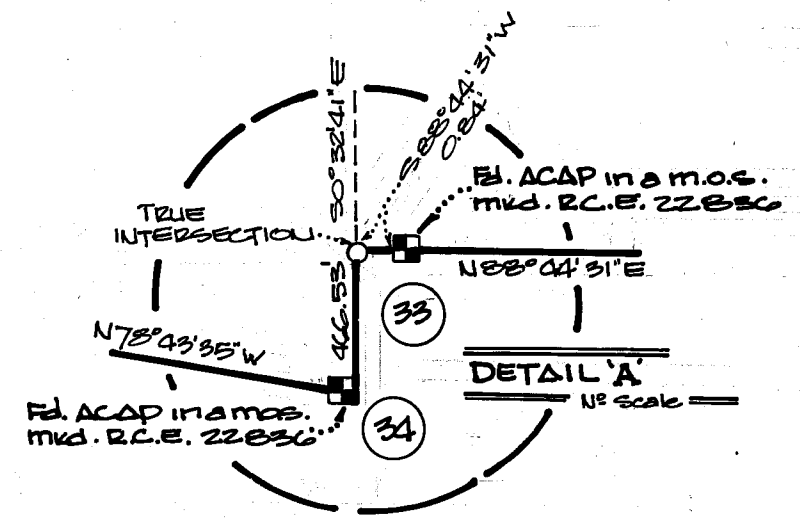

SURVEYOR'S STATEMENT

This map correctly represents a survey made by me or under my direction in conformance with the requirements of the Land Surveyors Act at the request of the U.S.D.A. Forest Service in June 1980.

Jay Burgess
 JAY A. BURGESS L.S. 4790

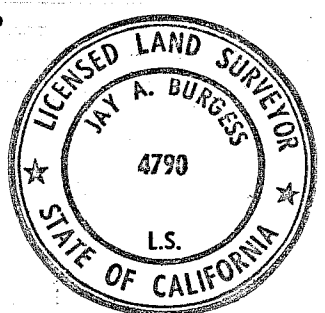

COUNTY SURVEYOR'S STATEMENT

This map has been examined in accordance with Section 8766 of the Land Surveyors Act this 27th day of January 1981.

County Surveyor: *Lawrence J. Brock*
 LAWRENCE J. BROCK
 R.C.E. 13528

Deputy: _____

RECORDER'S CERTIFICATE

Filed this 27th day of January 1981 at 9:02 A.M. in Book 7 of Record of Surveys at page 109110 at the request of the County Engineer.

Fee: \$ 7.00 File: 5562

County Recorder: _____
 ILA DIGGS

Deputy: *Bruce Cammack*

RECORD OF SURVEY FOR

PLUMAS NATIONAL FOREST LEE SUMMIT CADASTRAL SURVEY

In Sections 34 and 35, T.24 N., R.10E., Section 1, T.23 N., R.10E., and between Sections 6 and 7, T.23 N., R.11E., M.D.M. in the unincorporated territory of Plumas County, State of California.

BURGESS
 Land Surveys
 Redding, Ca.

1" = 1000'
 AUG. 1980
 ROBT. RIGGINS JR.
 SHEET 1 OF 2