

BASIS OF BEARINGS

A SOLAR OBSERVATION WAS TAKEN AT POINT 30, BACKSIGHT WAS POINT 20, BOTH LYING NEAR THE NORTH LINE OF SECTION 25, BETWEEN THE NE CORNER AND THE N 1/4 CORNER OF SECTION 25, T. 27N., R.7E. POINT 30 LIES S 73° 21' 34" W, 1525 FT FROM THE NE CORNER.

LEGEND

- ◆ Corner of Record, as noted in "Corner Descriptions"
- ⊗ Corner Trees, Accepted
- ⊙ Std. BLM BC, described in "Notes"
- Std. FS ACAP, described in "Notes"
- Forest Service Boundary
- Lines Surveyed
- - - Unsurveyed Lines, for calculations
- () Record of William Minto, 1875
- [] Record of Victor Barber, 1904
- ⊙ Key to Corner Descriptions

ABBREVIATIONS

N	North	JP	Jeffrey Pine
S	South, Section	PP	Ponderosa Pine
E	East	YP	Yellow Pine
W	West	SP	Sugar Pine
T	Township	WF	White Fir
R	Range	DF	Douglas Fir
C	Center	ACAP	Aluminum Cap
Std	Standard	BC	Brass Cap
Mon	Monument	LS	Land Surveyor
fwb	from which bears	mkd	marked
REC.	Record	dia.	diameter
BT	Bearing Tree	RM	Reference Monument
MOS	Mound of Stone	PNF	Plumas National Forest
lks.	Links	ODIP	Outside Diameter Iron Pipe
ch.	chains	FS	Forest Service
ft.	Feet	BLM	Bureau of Land Management
in.	inches	[]	Record of Jack Rabedew, 1975
USDl	United States Department of the Interior		
USDA	United States Department of Agriculture		
CAF	Collins Almond Forest (Collins Pine Timber Company)		
AM	AMENDED MONUMENT		

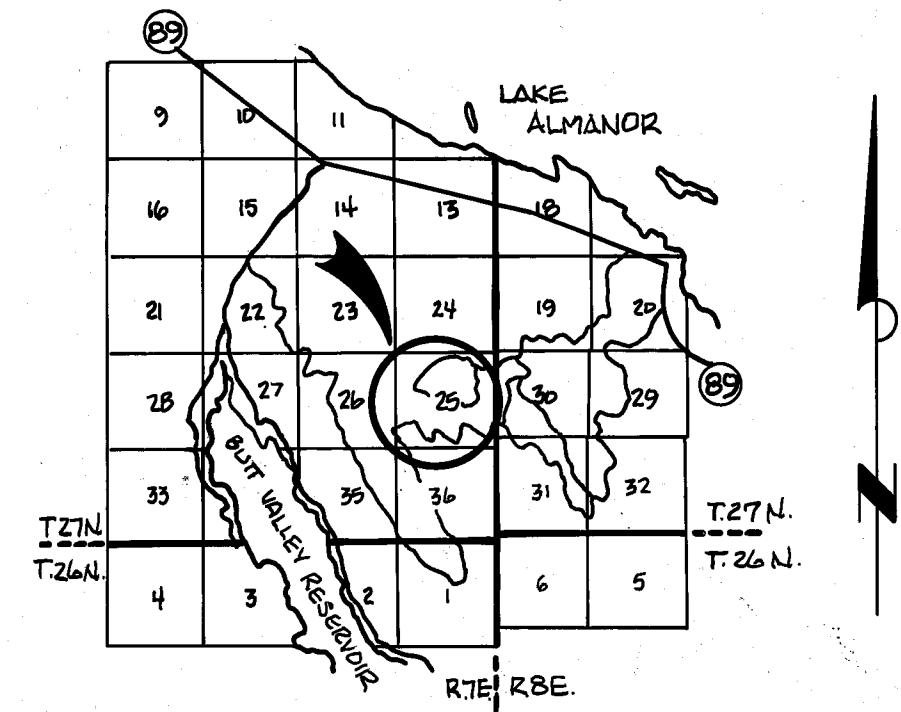

VICINITY MAP
1 inch = 2 miles

SURVEYOR'S STATEMENT

THIS MAP REPRESENTS A SURVEY MADE BY ME OR UNDER MY DIRECTION IN CONFORMANCE WITH THE LAND SURVEYORS ACT AT THE REQUEST OF THE UNITED STATES FOREST SERVICE IN JULY, 1986.

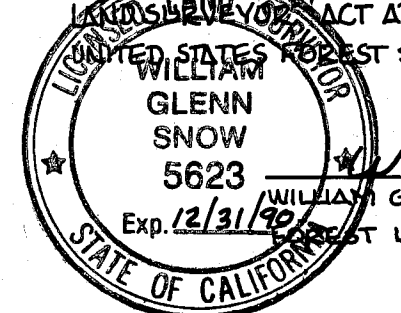

COUNTY SURVEYOR'S STATEMENT

THIS MAP HAS BEEN EXAMINED IN ACCORDANCE WITH SECTION 8766 OF THE LAND SURVEYORS ACT THIS 15th DAY OF APRIL, 1988.

Lawrence J. Brock
LAWRENCE J. BROCK, RCE 1352B
PLUMAS COUNTY SURVEYOR

RECORDER'S STATEMENT

FILED THIS 15th DAY OF APRIL, 1988, AT 1:15 P.M., IN BOOK 8 OF RECORDS OF SURVEY, AT PAGE 26-27, AT THE REQUEST OF THE COUNTY ENGINEER.

FEE \$ 7.00
FILE NO. 6905
ILA DIGGS
COUNTY RECORDER

by *Beth Cammack*
DEPUTY

RECORD OF SURVEY

LOCATED IN SECTION 25, T. 27N., R.7E., M.D.M. COUNTY OF PLUMAS, STATE OF CALIFORNIA FOR THE PLUMAS NATIONAL FOREST

HISTORY OF SURVEYS

IN 1875, WILLIAM MINTO, UNITED STATES DEPUTY SURVEYOR, SUBDIVIDED T.27N., R.7E., AND ALSO SURVEYED THE EAST LINE OF SAID TOWNSHIP.
IN 1904, VICTOR S. BARBER, U.S. DEPUTY SURVEYOR, RE-SURVEYED THE EAST LINE OF T.27N., R.7E.
JACK RABEDEW, BUREAU OF LAND MANAGEMENT CADASTRAL SURVEYOR, REMONUMENTED CERTAIN ORIGINAL CORNERS IN T.27N., R.7E., IN 1975.

NOTES

1. A STANDARD BUREAU OF LAND MANAGEMENT BRASS CAP (STD BLM BC) IS A 2 1/2-INCH OUTSIDE DIAMETER IRON PIPE WITH A 3 1/2-INCH BRASS CAP WITH USDl LOGO ENGRAVED.
2. A STANDARD FOREST SERVICE CAP (STD FS ACAP) IS A 2 1/2-INCH OUTSIDE DIAMETER ALUMINUM PIPE WITH A 3 1/4-INCH ALUMINUM CAP WITH USDA LOGO ENGRAVED. A DRIVE-IN MONUMENT IS A 5/8-INCH DIAMETER ALUMINUM ROD WITH A 3/4-INCH ALUMINUM CAP WITH USDA LOGO ENGRAVED.

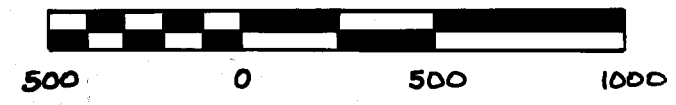

SCALE: 1" = 500'