

- LEGEND**
- () Record per 1 PM 32
 - ⊘ Fd 1/2" Rebar per 2 P.M. 29 tagged RCE 11173
 - ⊙ Fd 3/4" I.P. per 1 P.M. 32 tagged RCE 11173 or as noted
 - Set 1/2" Rebar RCE 22836
 - ⊘ I.D.P Inside Diameter Iron Pipe
 - { } Record per 2 PM 29

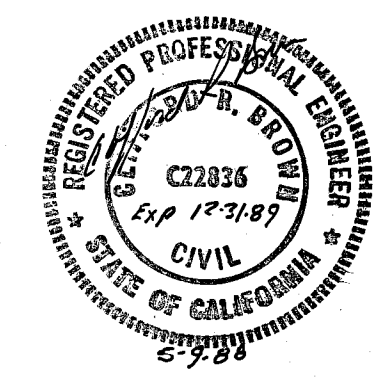

NOTES

1. This Record of Survey was prepared to reflect a Lot Line Adjustment for which a resolution is recorded in Book 485 of Official Records at page 108,109.

ROAD EASEMENT DATA

COURSE	DELTA or RADIUS			ARC OR DISTANCE				
	BEARING	LT	CL	RT	LT	CL	RT	
A	N83°33'20"W	-	-	-	10.04'	-	10.04'	
B	S0°44'19"W	-	-	-	80.75'	83.92'	87.09'	
C	S24°23'18"E	-	-	-	50.40'	52.62'	54.84'	
D	S4°23'18"E	40'	30'	20'	58.91'	44.19'	29.46'	tan = 27.20' ∠
E	S60°W	-	-	-	50.15'	59.03'	67.91'	
F	N71°36'22"W	-	-	-	13.37'	-	13.37'	
G	N83°33'20"W	-	-	-	-	50.00'	-	
H	N71°36'22"W	-	-	-	-	-	49.03'	

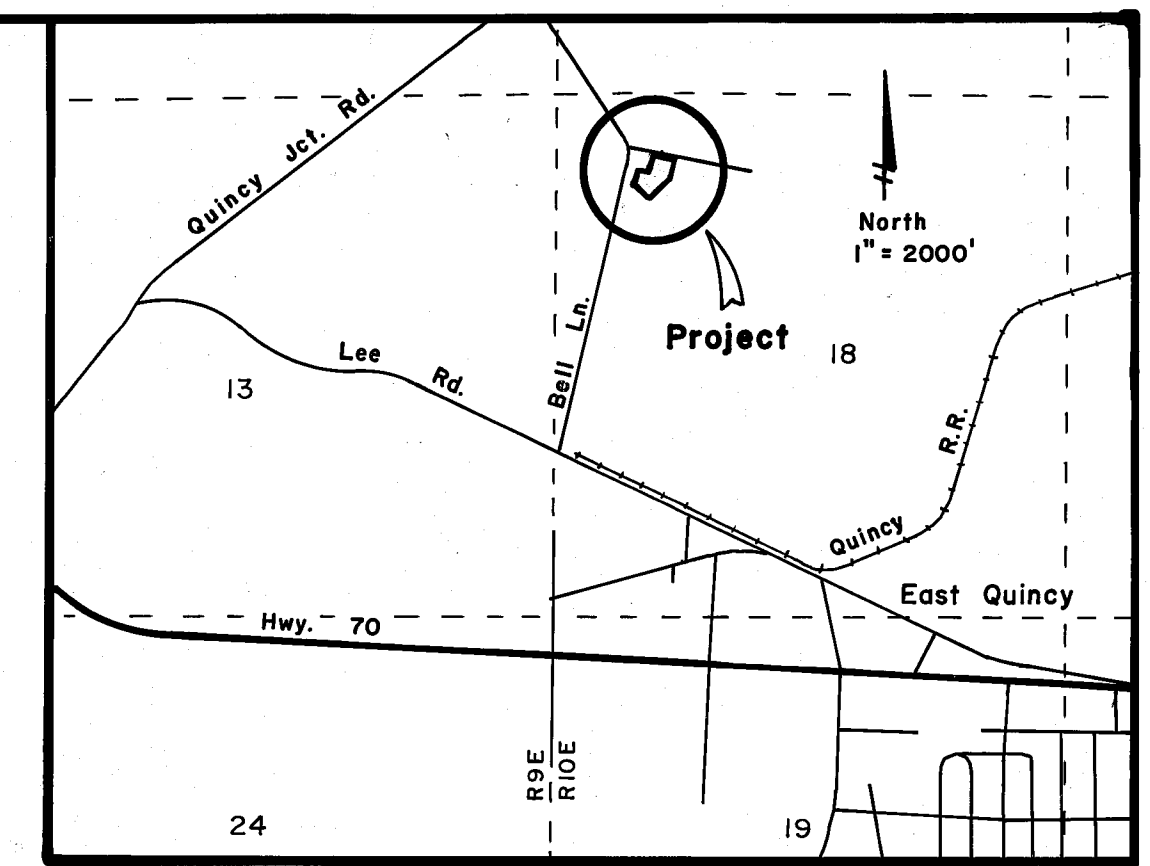

LOCATION MAP
T24N, R10E, Sec. 18 MDBM

SURVEYOR'S STATEMENT

This map correctly represents a survey made by me or under my direction in conformance with the requirements of the Land Surveyors Act at the request of Henry J. and Betty N. Klement in Oct. 1987.

Clifford R. Brown
Clifford R. Brown RCE 22836

COUNTY SURVEYOR'S STATEMENT

This map has been examined in accordance with Section 8766 of the Land Surveyor's Act this 5th day of August, 1988. This survey does not constitute a subdivision under Division 2 of Title 7 of the Government Code.

Lawrence J. Brock
Lawrence J. Brock RCE 13528

COUNTY RECORDER'S STATEMENT

Filed this 5th day of August, 1988 at 10:53 A.m. in Book 8 of Records of Surveys, at page 34, at the request of the County Engineer.

Fee \$ 5.00

ILA DIGGS
County Recorder

By *Laitha Williams*
Deputy

RECORD OF SURVEY
for
Henry J. and Betty N. Klement
Rt. 1 Box 94
Quincy, CA. 95971 (916) 283-2147

Within Section 18, T24N, R10E MDBM
north of East Quincy, Plumas County, California

Engineer: Cliff Brown Engineering & Survey
Rt. 1 Box 480 B
Quincy, CA. 95971 (916) 283-3959