

CORNER DESCRIPTIONS

QUARTER CORNER: 4 and 9, T24N, R16E

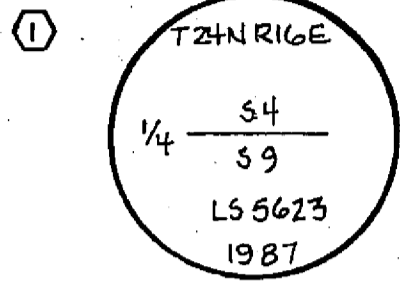

FOUND: 2-1/2 x 3 FT MOS WITH ORIGINAL MARKED STONE (1879 REC: 18"x9"x7" STONE IN 4 x 2 FT MOS).

FWB: DEPRESSION WITH UPROOTED 30" STUMP ALONGSIDE, N 14-57 E, 90.3 FT (28" PINE, N 5° E, 141 LKS);

DEPRESSION WITH UPROOTED 34" STUMP ALONGSIDE, S 34-42 W, 31.6 FT (30" PINE, S 33° W, 50 LKS);

SET: STD USFS MON, UP 8" IN 3 x 2 x 1 FT MOS.

FWB: 15" JP, S 66-46 W, 29.8 FT, SCRIBED "1/4 S 9 BT"; and

17" JP, N 35-31 W, 27.8 FT, SCRIBED "1/4 S 4 BT".

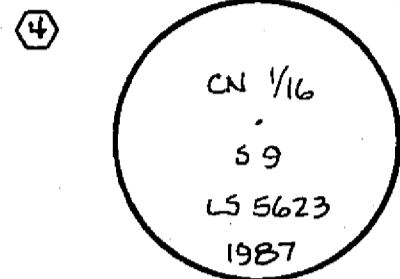

CENTER-NORTH SIXTEENTH CORNER OF 9, T24N, R16E

FOUND: 1" ODIP, UP 3", TAGGED LS 3336. DID NOT ACCEPT!

SET: STD USFS DRIVE-IN MON, UP 10" IN A 1-1/2 x 1-1/2 x 1/2 FT MOS.

FWB: 20" WF, S 52-16 W, 27.3 FT, SCRIBED "C N 1/16 S 9 BT";

15" WF, N 13-04 W, 29.7 FT, SCRIBED "C N 1/16 S 9 BT"; and

FOUND 1" ODIP, N 68-41-29 W, 4.32 FT.

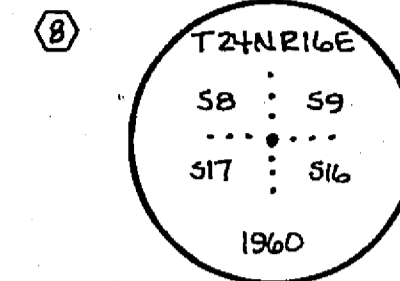

SECTION CORNER: 8, 9, 16 and 17, T24N, R16E

FOUND: 2" ODIP WITH 2-1/2" BC, UP 12", IN 4 x 4 x 1/2 FT MOS.

FWB: 36" PINE STUMP, N 30-22 E, 57.9 FT, SCRIBING VISIBLE (40" PINE, N 30° E, 90 LKS);

35" JP, S 10-12 E, 76.6 FT, HEALED BLAZE (8" PINE, S 10° E, 116 LKS);

36" PINE STUMP, S 55-46 W, 29.4 FT, SCRIBING VISIBLE (33" PINE, S 58° W, 43 LKS);

36" PINE STUMP, N 57-38 W, 72.5 FT, SCRIBING VISIBLE (38" PINE, N 57° W, 106 LKS);

15" JP, N 32-57 E, 20.3 FT, SCRIBED "T24N R16E S 9 BT" (NEW BT);

18" JP, S 68-45 W, 13.2 FT, SCRIBED "T24N R16E S 17 BT" (NEW BT); and

11" JP, N 21-35 W, 7.1 FT, SCRIBED "T24N R16E S 8 BT" (NEW BT).

EAST SIXTEENTH CORNER: 4 and 9, T24N, R16E

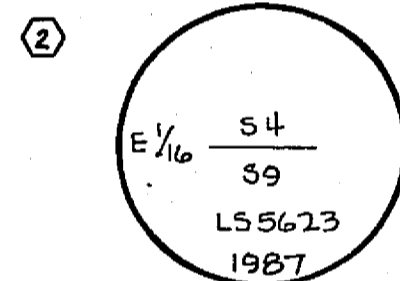

FOUND: 3/4" ODIP, UP 4" IN 2 x 1 FT MOS. ACCEPTED PIPE.

SET: STD USFS DRIVE-IN MON, UP 12" IN 2-1/2 x 2-1/2 x 1/2 FT MOS. BURIED FOUND PIPE ALONGSIDE.

FWB: 7" PP, S 23-45 E, 58.9 FT, SCRIBED "1/16 S 9 BT"; and

6" PP, N 25-30 W, 41.0 FT, SCRIBED "1/16 S 4 BT".

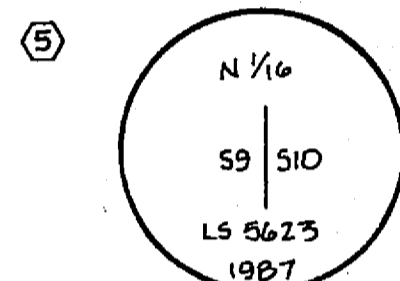

NORTH SIXTEENTH CORNER: 9 and 10, T24N, R16E

FOUND: 1" ODIP, UP 5", TAGGED LS 3336. ACCEPTED PIPE.

SET: STD USFS DRIVE-IN MON, UP 4" IN 2 x 2 x 1/2 FT MOS. BURIED FOUND PIPE ALONGSIDE.

FWB: 18" JP, S 82° W, 14.0 FT, SCRIBED "N 1/16 S 9 BT"; and

22" JP, S 45-15 E, 52.5 FT, SCRIBED "N 1/16 S 10 BT".

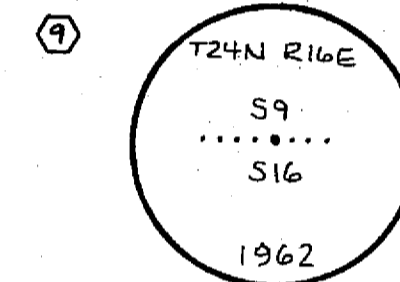

QUARTER CORNER: 9 and 16, T24N, R16E

FOUND: 2" ODIP WITH 2-1/2" BC, UP 12", IN 3 x 1-1/2 x 1/2 FT MOS.

FWB: 25" JP, N 71-02 E, 34.7 FT, HEALED BLAZE (8" PINE, N 71° E, 52 LKS);

27" JP, S 62-19 E, 27.1 FT, HEALED BLAZE (8" PINE, S 60° E, 41 LKS).

SECTION CORNER: 3, 4, 9 and 10, T24N, R16E

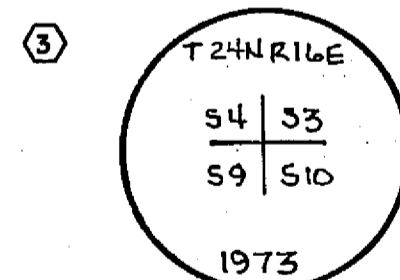

FOUND: STD BLM BC (2-1/2" ODIP WITH 3-1/4" BC), UP 12" IN 3 x 2 x 2 FT MOS.

FWB: 29" JP, N 26-24 E, 88.0 FT, HEALED BLAZE (12" PINE, N 26° E, 33 LKS);

DEPRESSION WITH UPROOTED 6" STUMP ALONGSIDE, S 29-38 E, 20.6 FT, SCRIBING VISIBLE (10" PINE, S 30° E, 32 LKS);

39" JP, N 50-15 W, 113.7 FT, HEALED BLAZE (10" PINE, N 50° W, 170 LKS);

22" JP, S 26-50 W, 66.4 FT, SCRIBED "T24N R16E S 9 BT" (NEW BT)

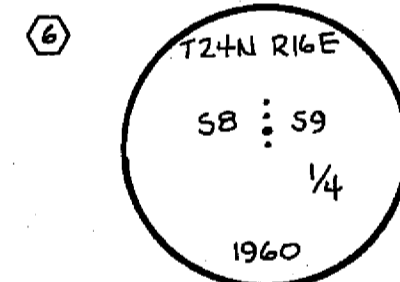

QUARTER CORNER: 8 and 9, T24N, R16E

FOUND: 2" ODIP WITH 2-1/2" CAP, UP 17", IN 2-1/2 x 2-1/2 x 1/2 FT MOS. FOUND ORIGINAL STONE IN MOS.

FWB: DEPRESSION WITH UPROOTED 34" STUMP ALONGSIDE, N 73-30 E, 53 FT (26" PINE N 74° E, 82 LKS);

17" STUMP, S 83-35 W, 24.2 FT (5" MOHOGANY, S 83° W, 37 LKS);

13" JP, N 77-47 E, 61.2 FT, SCRIBED "1/4 S 9 BT" (NEW BT); and

10" JP, S 61-38 W, 59.0 FT, SCRIBED "1/4 S 8 BT" (NEW BT).

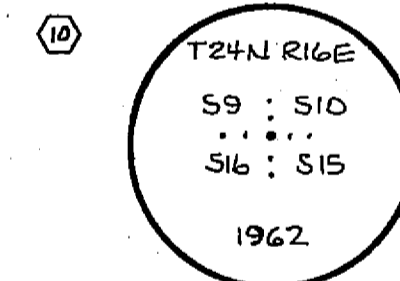

SECTION CORNER: 9, 10, 15 and 16, T24N, R16E

FOUND: 2" ODIP WITH 2-1/2" BC, UP 10", IN 3 x 3 x 1 FT MOS, WITH ORIGINAL MARKED STONE (24"x16"x8" VOLCANIC STONE IN MOS).

FWB: 33" PP, S 30-31 E, 111.5 FT, HEALED BLAZE (18" PINE, S 29° E, 166 LKS);

42" PP, S 9-12 W, 65.0 FT, HEALED BLAZE (30" PINE, S 12° W, 97 LKS);

17" PP, S 76-00 E, 138.2 FT, SCRIBED "T24N R16E S 15 BT" (NEW BT); and

21" JUNIPER, N 8-18 W, 96.4 FT, UNABLE TO SCRIBE BECAUSE OF KNOTS (NEW BT).

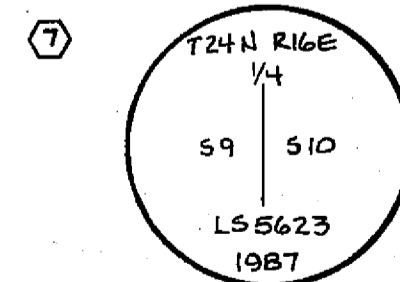

QUARTER CORNER: 9 and 10, T24N, R16E

FOUND: 1/2" REBAR, UP 2", WITH CAP STAMPED LS 2843. DID NOT ACCEPT!

SET: STD USFS MON, UP 14" IN 3-1/2 x 3-1/2 x 1/2 FT MOS.

FWB: 11" WF, N 80-42 W, 24.75 FT, SCRIBED "1/4 S 10 BT" (NEW BT); and

16" WF, S 6-21 W, 3.94 FT, SCRIBED "1/4 S 9 BT" (NEW BT).

RECORD of SURVEY

LOCATED IN SECTION 9
TOWNSHIP 24 NORTH, RANGE 16 EAST
MOUNT DIABLO MERIDIAN
COUNTY OF PLUMAS
STATE OF CALIFORNIA
FOR THE PLUMAS NATIONAL FOREST