

BASIS OF BEARINGS

The Basis of Bearings of this map is a boundary line of Parcel 1, taken between points indicated as N 87°05'09" W shown in Book 8 PM 21, Plumas County records.

NOTE:

This Record of Survey was prepared to reflect a Lot Line Adjustment for which a resolution is Recorded in Book 541 of Official Records at page 228.

LEGEND

- SET 5/8" Rebar & Plastic Cap LS 2843
- FOUND Rebar with Aluminum Cap LS 2843
- FOUND 1/2" or 3/4" OPEN I.P. as shown, SET TAG LS 2843
- (R1) RECORD per 2 M 13.
- (R2) RECORD per 8 PM 21
- (R3) RECORD per 541 O.R. 230

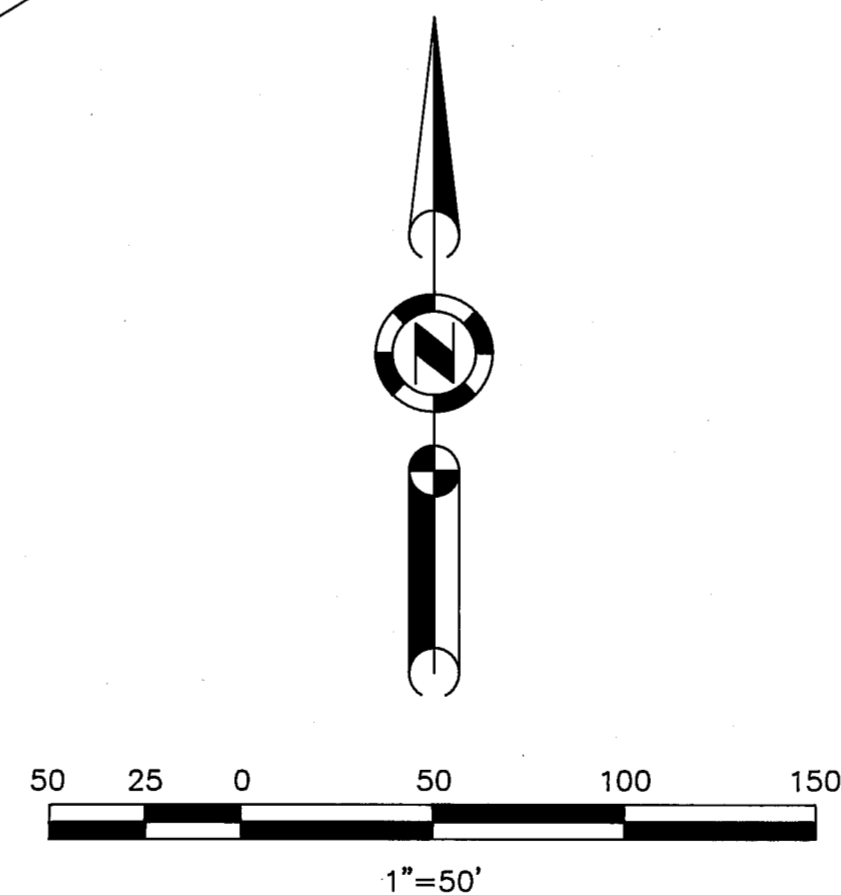

SURVEYOR'S STATEMENT

This map correctly represents a survey made by me or under my direction in conformance with the requirements of the Land Surveyors' Act at the request of Ted Zmak in Feb. 1991.

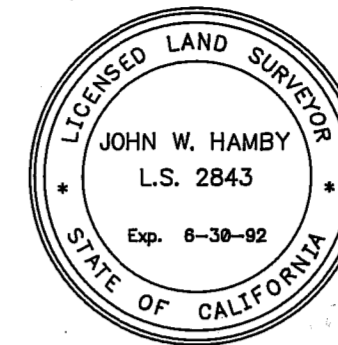

John W. Hamby
John W. Hamby LS 2843

COUNTY SURVEYOR'S STATEMENT

This map has been examined in accordance with Section 8766 of the Land Surveyors' Act this 16TH day of MAY, 1991

Lawrence J. Brock
Lawrence J. Brock RCE 13528
PLUMAS COUNTY SURVEYOR
License Expiration Date 3/31/93

RECORDER'S STATEMENT

Filed this 16TH day of MAY, 1991 at 3:10 P.m. in Book 9 of Record of Surveys, at page 4, at the request of the County Engineer.

Fee 5.00
File No. 3372

Judith Wells
County Recorder
by *Beth Cammack*
Deputy

RECORD OF SURVEY for THEODORE & CATHERINE ZMAK

A portion of Parcel 1, 8 PM 21
Located in the South 1/2 of Section 8
T. 23 N., R 14 E., M.D.B. & M.

PLUMAS COUNTY — CALIFORNIA
SCALE 1" = 50' FEB. 1991

HAMBY SURVEYING INC.
P.O. Box 1209
PORTOLA, CA. 96122
Phone 916-832-5571

SHEET 1 OF 1