

T21N R12E
CORNER NO. 75

$\frac{1}{4}$ **S2**
S11
LS 3966
1993

FD. 3/4" PIPE WITH PLASTIC CAP LS 11173.
SET STD USFS MONUMENT IN A MOUND OF STONE.
CORNER FALLS NEAR THE TOP OF A NORTH SLOPE,
350'± NORTH OF A ROAD.

FD. A 12" RED FIR BEARS S68 1/4"W, 10.8'-HB
REC. A 6" RED FIR BEARS S68 25"W, 10.8'(4 RS 8)
FD. A 14" RED FIR BEARS N34 1/4"W, 13.4'-HB
REC. A 6" RED FIR BEARS N33 15"W, 13.5'(4 RS 8)

T22N R12E CORNER NO. 79

S29 **S28**
S32 **S33**
LS 3966
1993

FD. 6" X 6" X 18" STONE WITH NOTCHES BY A
MOUND.
SET STD USFS MONUMENT IN A MOUND OF STONE
CORNER FALLS ON AN EAST SLOPE, 70'± FROM RIDGE
TOP IN A BRUSH FIELD.

A 12" YELLOW PINE BEARS N36"W, 4.8'-SBT
"T22N R12E S29 BT"
A 5" YELLOW PINE BEARS S40 1/2"E, 38.8'-SBT
"X BT"
A 10" YELLOW PINE BEARS S39 1/4"W, 23.8'-SBT
"T22N R12E S32 BT"

T22N R12E
CORNER NO. 81

$\frac{1}{4}$ **S29**
S32
LS 3966
1993

FD. MOUND OF STONE WITH STONE MARKED "1/4".
SET STD USFS MONUMENT IN A MOUND OF STONE
CORNER FALLS IN A FLAT, 320'± WEST OF HIGHWAY.

AN 11" CEDAR BEARS S3 1/4"E, 13.6'-SBT
"1/4 S32 BT"
A 7" WHITE FIR BEARS N42 3/4"E, 26.2'-SBT
"1/4 S29 BT"

T22N R11E CORNER NO. 87

S25 **S30**
S31
1942

FD. 2 1/2" BRASS CAP ON A 2" IRON PIPE IN A
MOUND OF STONE.
CORNER FALLS ON A NORTH SLOPE, 300'± SOUTH OF
A TRAIL.

FD. AN 18" WHITE PINE BEARS S41 1/4"E, 47.4'-VS
REC. A 15" SUGAR PINE BEARS S41 1/4"E, 46.9' (GLO 1942)
FD. A 50" WHITE PINE BEARS N85 1/4"E, 55.2'-VS
REC. A 30" SUGAR PINE BEARS N86 1/4"E, 55.4' (GLO 1942)

T22N R11E | **R12E** CORNER NO. 88

S36 **S31**
S8 **S1**
T21N
1942

FD. 3 1/2" BLM BRASS CAP ON A 3" PIPE IN A
MOUND OF STONE.
CORNER FALLS ON AN EAST SLOPE, 50'± NORTH OF
AN EAST-WEST DRAW.

FD. A 36" FIR SNAG BEARS S19 1/2"E, 80.9'-HB
REC. A 36" FIR BEARS S19 1/2"E, 80.5' (GLO 1942)
FD. AN 11" YELLOW PINE BEARS N87 1/2"E, 78.0'-HB
REC. AN 8" YELLOW PINE BEARS N87 3/4"E, 79.9' (GLO 1942)
FD. AN 18" SUGAR PINE BEARS S10"W, 74.4'-HB
REC. A 10" SUGAR PINE BEARS S11 3/4"W, 75.9' (GLO 1942)
FD. A 31" FIR BEARS N68 1/2"W, 97.0'-VS
REC. A 30" FIR BEARS N68"W, 95.7' (GLO 1942)

$E \frac{1}{16}$ **S34**
S3
LS 3966
1993

CORNER NO. 89

SET A 3 1/2" ALUMINUM CAP ON A #5 REBAR IN A
MOUND OF STONE.
CORNER FALLS ON A ROCKY NORTH SLOPE.

A 7" WHITE FIR BEARS S4"E, 9.9'-SBT
"E 1/16 S3 BT"
A 6" WHITE FIR BEARS N69"W, 20.6'-SBT
"E 1/16 S34 BT"

$W \frac{1}{16}$ **S35**
S2
LS 3966
1993

CORNER NO. 90

FD. A PLASTIC PLUG, RCE 11173, ON A #4 REBAR.
SET 3 1/4" ALUMINUM CAP ON A 5/8" DRIVE
IN ROD IN A MOUND OF STONE
CORNER FALLS ON A NORTHWEST SLOPE, 500'±
NORTHWEST OF A CAMP.

A 9" WHITE FIR BEARS S48 1/4"E, 37.9'-SBT
"W 1/16 S2 BT"
A 9" CEDAR BEARS N4 1/4"E, 61.4'-SBT
"W 1/16 S35 BT"

NE 1/16 + **S3** CORNER NO. 91

LS 3966
1993

SET A 2" ALUMINUM CAP ON A #5 REBAR IN A
MOUND OF STONE.
CORNER FALLS ON A NORTHEAST SLOPE.

A 10" DOUGLAS FIR BEARS N18 1/4"E, 5.5'-SBT
"NE 1/16 S3 BT"
A 6" DOUGLAS FIR BEARS S59"E, 24.9'-SBT
"NE 1/16 S3 BT"

NW 1/16 + **S2** CORNER NO. 92

LS 3966
1993

SET A 2" ALUMINUM CAP ON A #5 REBAR IN A
MOUND OF STONE.
CORNER FALLS ON A WEST SLOPE.

A 10" SUGAR PINE BEARS N88"E, 29.4'-SBT
"NW 1/16 S2 BT"
A 4" WHITE FIR BEARS S11 1/2"W, 4.6'-SBT
"X BT"

T21N R12E
 $\frac{1}{4}$ CORNER NO. 93

S9 **S10**
LS 3966
1993

SET STD USFS MONUMENT IN A MOUND OF STONE
CORNER FALLS ON A SOUTHWEST SLOPE IN TIMBER,
500'± WEST OF A ROAD.

FD. A 36" WHITE FIR BEARS N17"E, 5.9'-HB
REC. A 34" WHITE FIR BEARS N21"E, 5.9' (USFS CORNER
RECORD FILE No. G-13)
A 7" YELLOW PINE BEARS S71 1/4"W, 19.7'-SBT
"1/4 S9 BT"

CORNER NOTES

H.B. = HEALED BLAZE
V.S. = VISIBLE SCRIBING
S.B.T. = SCRIBED AS A BEARING TREE
STD USFS MON. = 3 1/4" ALUMINUM CAP
ON A 5/8" STEEL ROD

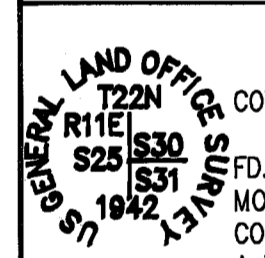

RECORD OF SURVEY
FOR
USDA FOREST SERVICE

"EASTSIDE '92"
IN SECTIONS 1, 12, AND 21 OF T 24 N, R 8 E,
IN SEC 31 OF T 25 N, R 8 E,
IN SECTIONS 31, 32, 33 AND 34, T 22 N, R 12 E,
AND IN SECTIONS 1, 2, 3 AND 4, T 21 N, R 12 E, MDM
IN THE UNINCORPORATED AREA OF PLUMAS
COUNTY, STATE OF CALIFORNIA

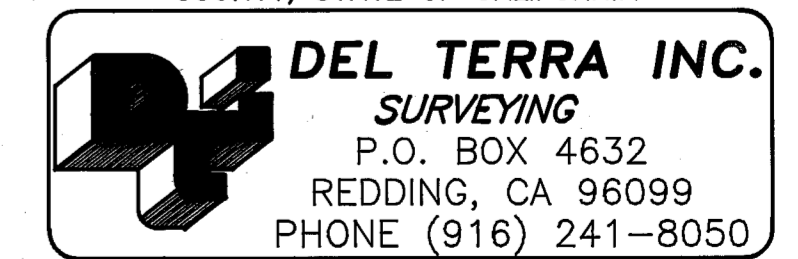

DATE: MARCH, 1994
SHEET: 9 OF 9