

LEGEND

- SET 1/2 INCH REBAR AND CAP P.L.S. 6051
- FOUND 1/2 INCH REBAR AND CAP L.S. 2843
- ▼ FOUND 1/2 INCH REBAR AND CAP R.C.E. 11173 OR NOTED
- FOUND 1/2 INCH REBAR SET CAP P.L.S. 6051
- + LOCATION ESTABLISHED FROM RECORD, NOTHING FOUND OR SET

[1] KEY TO CORNER NOTE

(A) RECORD INFORMATION PER BOOK 3 OF PARCEL MAPS, PAGE 5

(B) RECORD INFORMATION PER BOOK 10 OF RECORDS OF SURVEYS, PAGE 89

(D) RECORD INFORMATION PER BOOK 5 OF RECORDS OF SURVEYS, PAGE 53

(E) RECORD INFORMATION PER BOOK 27 OF OFFICIAL RECORDS, PAGE 164

(F) RECORD INFORMATION PER BOOK 722 OF OFFICIAL RECORDS, PAGE 540

(G) RECORD INFORMATION PER BOOK 1 OF SUBDIVISION MAPS, PAGE 2

(C/A) INFORMATION CALCULATED FROM RECORD INDICATED

CORNER NOTE

[1] NOTHING FOUND OR SET, FROM WHICH POINT FOUND A 1/2 INCH REBAR AND CAP L.S. 2843 N 22-47-00 W, A DISTANCE OF 0.14 FEET.

[2] WITNESS CORNER SET ON PROPERTY LINE AT THE INDICATED DISTANCE TO THE NORTH BANK OF THE FEATHER RIVER AS LOCATED IN MARCH, 2002.

[3] INDICATED MONUMENT WAS ACCEPTED AS REPRESENTING APPROPRIATE PROPERTY CORNER OF LOT 8 (1 M 2) AND THE LINE ESTABLISHED FROM THE MONUMENTS WAS ACCEPTED AS THE EASTERLY PROPERTY LINE OF THE AMERICAN LEGION PARCEL.

COUNTY SURVEYOR'S STATEMENT

THIS MAP HAS BEEN EXAMINED IN ACCORDANCE WITH SECTION 8766 OF THE LAND SURVEYORS ACT THIS 16th DAY OF August 2002.

R. Tom Hunter
R. TOM HUNTER, R.C.E. 30515
PLUMAS COUNTY SURVEYOR
LICENSE EXP. 03-31-04



COUNTY RECORDERS STATEMENT

FILED THIS 20th DAY OF August 2002 AT 2:34 P. M. IN BOOK 12 OF RECORDS OF SURVEYS, AT PAGE 78, AT THE REQUEST OF THE COUNTY SURVEYOR.

FEE \$ 800
FILE No. 2002-8108

JUDITH WELLS
COUNTY RECORDER

BY: *Denny Samuel*
DEPUTY

RECORD OF SURVEY FOR LEE & BEVERLY J. WEHRMAN OF THE PROPERTY DESCRIBED IN BOOK 722 OF OFFICIAL RECORDS AT PAGE 540 WITHIN THE SOUTHWEST 1/4 OF SECTION 36, TOWNSHIP 23 NORTH, RANGE 13 EAST, M.D.M. PORTOLA PLUMAS COUNTY CALIFORNIA

SCALE 1 INCH = 40 FEET MARCH 2002

Tibbodeaux Surveying
P.O. Box 1960 / 565 Ridge St.
Portola, CA 96122
(530) 832-5772

D:\01-34BL\01-34-1 SHEET 1 OF 1

SURVEYOR'S STATEMENT

THIS MAP CORRECTLY REPRESENTS A SURVEY MADE BY ME OR UNDER MY DIRECTION IN CONFORMANCE WITH THE REQUIREMENTS OF THE LAND SURVEYORS ACT AT THE REQUEST OF LEE WEHRMAN IN MARCH 2002.

Gerald Joseph Tibbodeaux
GERALD JOSEPH TIBBODEAUX P.L.S. 6051
LICENSE EXP. 06-30-06

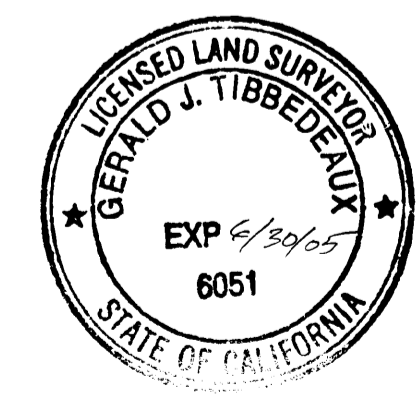

CURVE TABLE

CURVE	DELTA ANGLE	RADIUS	ARC	TANGENT	CHORD	CHORD BEARING
C 1	37° 38' 45"	128.62	84.51	43.84	83.00	S 62° 25' 02" W
C 2	47° 26' 22"	132.64	109.82	58.28	106.71	S 86° 29' 33" W
C 3	76° 07' 29"	98.09	130.33	76.81	120.95	S 79° 50' 12" W
C 4	09° 44' 07"	1533.88	260.63	130.63	260.31	S 60° 38' 57" W

BASIS OF BEARINGS

THE SOUTHERLY PROPERTY LINE OF PARCEL 1, SHOWN AS N 67-13-00 E IN BOOK 3 OF PARCEL MAPS AT PAGE 5 IS THE BASIS OF BEARINGS SHOWN ON THIS MAP.