

MONUMENTATION

POINT		NAD 83 EPOCH 1991.35 GEODETIC COORDINATES (D-M-S)			95% STANDARD ERROR (m)			CCS 83 ZONE I (1991.35) (m)		DESCRIPTION	REFERENCE	CONVERGENCE (D-M-S)	COMBINED GRID FACTOR
NAME	NGS PID	LATITUDE (N)	LONGITUDE (W)	ELLIP. HT.	LAT.	LONG.	E.H.	NORTHING	EASTING			Y	
D 143	KS0060	39-48-33.79673	120-14-06.59636	1473.02	FIXED	FIXED	FIXED	554383.875	2151122.074	FOUND PER NGS DATA SHEET		1-09-14.4	0.99982285
SAGE	KS1349	39-47-27.28372	120-02-19.76431	1532.79	FIXED	FIXED	FIXED	552690.346	2167978.028	FOUND PER NGS DATA SHEET		1-16-56.6	0.99981925
W 141	LT0066	40-02-13.43637	120-07-05.66964	1280.31	FIXED	FIXED	FIXED	579866.679	2160589.882	FOUND PER NGS DATA SHEET		1-13-49.6	0.99979046
HPGN D CA 03 MN	AE9837	39-46-37.67145	120-33-57.66433	1467.09	FIXED	FIXED	FIXED	550285.496	2122852.762	FOUND PER NGS DATA SHEET		0-56-15.6	0.99983390
HPGN D CA 03 MO	AE9836	39-49-06.38172	120-23-29.10603	1465.35	FIXED	FIXED	FIXED	555131.186	2137725.344	FOUND PER NGS DATA SHEET		1-03-06.6	0.99982127
HAWLEY	KS1384	39-49-05.39038	120-22-29.82966	1466.55	0.010	0.007	0.017	555126.628	2139135.526	FOUND PER NGS DATA SHEET PUBLISHED COORDINATES NOT ACCEPTED		1-03-45.3	0.99982117
E 143	KS0061	39-48-35.35859	120-16-29.25114	1467.43	0.008	0.006	0.014	554364.464	2147728.382	FOUND PER NGS DATA SHEET		1-07-41.1	0.99982359
G 143	KS0063	39-49-02.42210	120-21-03.61196	1467.41	0.010	0.008	0.020	555073.401	2141187.537	FOUND PER NGS DATA SHEET		1-04-41.7	0.99982128
F 91		39-49-24.68072	120-24-14.14283	1473.07	0.010	0.007	0.017	555675.912	2136644.069	FOUND T-BAR AND BATHEY CAP IN CONCRETE STAMPED "CM F 91"		1-02-37.1	0.99981851
F 92		39-49-21.77619	120-23-54.90719	1478.24	0.010	0.006	0.015	555594.687	2137103.104	FOUND T-BAR AND BATHEY CAP IN CONCRETE STAMPED "CM F 92"		1-02-49.7	0.99981795
CMON		39-48-34.35517	120-18-36.95636	1483.96	0.009	0.007	0.017	554274.328	2144691.773	FOUND 6" x 6" CONCRETE R/W MONUMENT		1-06-17.6	0.99982109
CM 77.95		39-49-20.45356	120-26-08.14312	1491.85	0.014	0.008	0.020	555496.659	2133935.610	SET 3/4" REBAR AND ALUMINUM CALTRANS CAP STAMPED "CM 77.95"		1-01-22.6	0.99981593
CM 91.00		39-48-34.15644	120-11-52.97060	1480.96	0.008	0.007	0.015	554459.657	2154299.825	FOUND 3/4" REBAR AND ALUMINUM CALTRANS CAP STAMPED "CM 91.00"		1-10-41.8	0.99982158
CM 91.22		39-48-33.05284	120-11-32.44132	1482.09	0.010	0.008	0.019	554435.683	2154788.765	SET 3/4" REBAR AND ALUMINUM CALTRANS CAP STAMPED "CM 91.22"		1-10-55.2	0.99982150

TO OBTAIN GROUND DISTANCES DIVIDE GRID DISTANCE BY COMBINED GRID FACTOR

RECORDER'S STATEMENT

FILED THIS 10th DAY OF April 2003
 AT 11:15 a.m.
 IN BOOK 12 OF RECORD SURVEYS AT PAGE 121
 AT THE REQUEST OF THE COUNTY SURVEYOR

(SIGNED) _____
 KATHLEEN WILLIAMS
 COUNTY RECORDER

BY (SIGNED) Larrie Sieck
 DEPUTY COUNTY RECORDER

NO FEE: STATE BUSINESS DOCUMENT # 2003-3838

HPGN D CA 03 MN

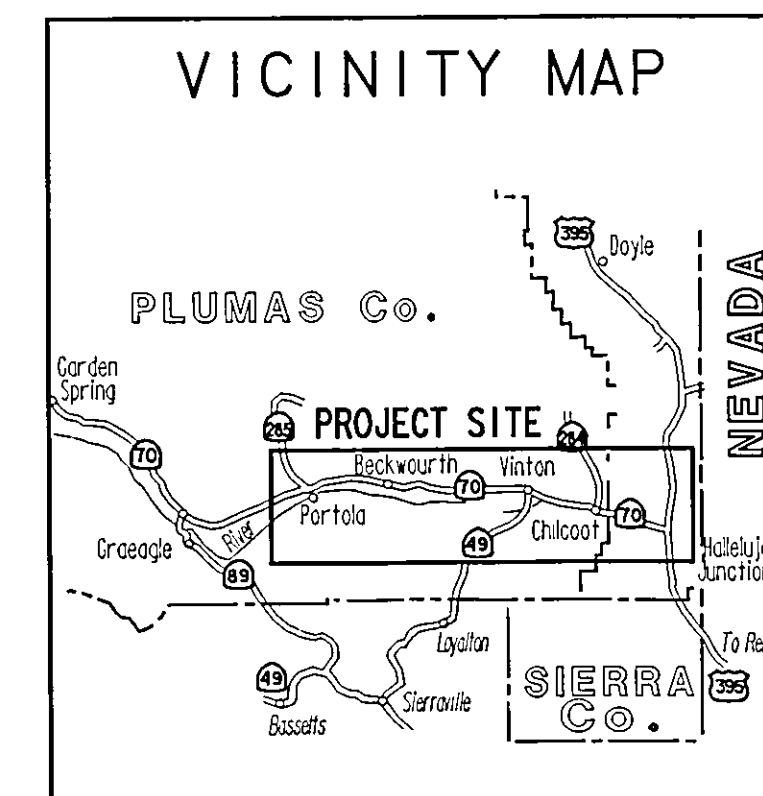
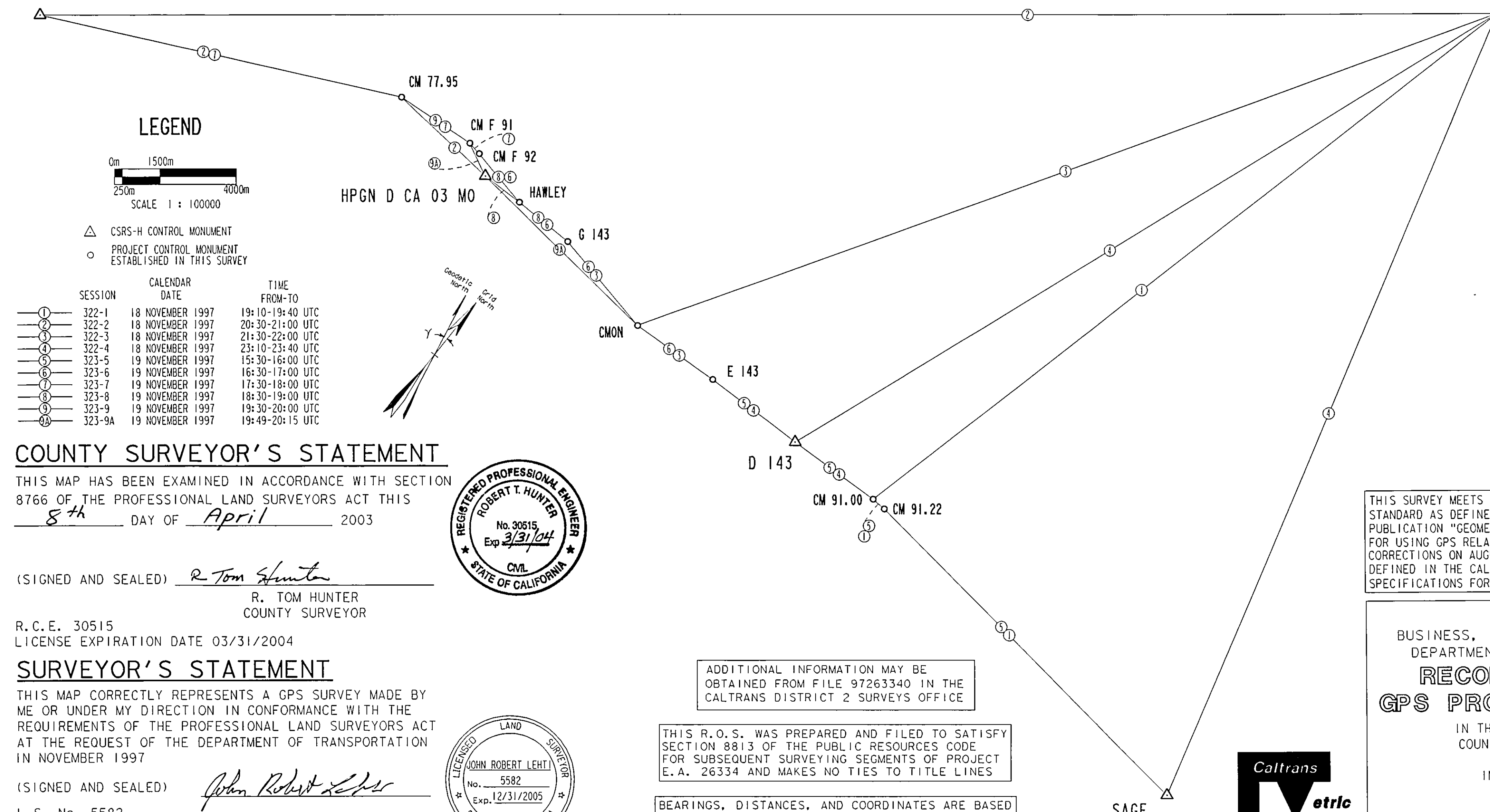

COUNTY SURVEYOR'S STATEMENT

THIS MAP HAS BEEN EXAMINED IN ACCORDANCE WITH SECTION 8766 OF THE PROFESSIONAL LAND SURVEYORS ACT THIS 8th DAY OF April 2003

(SIGNED AND SEALED) R. Tom Hunter
 R. TOM HUNTER
 COUNTY SURVEYOR

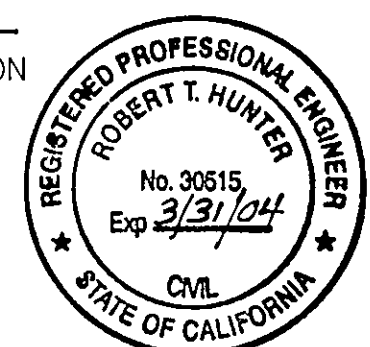

R.C.E. 30515
 LICENSE EXPIRATION DATE 03/31/2004

SURVEYOR'S STATEMENT

THIS MAP CORRECTLY REPRESENTS A GPS SURVEY MADE BY ME OR UNDER MY DIRECTION IN CONFORMANCE WITH THE REQUIREMENTS OF THE PROFESSIONAL LAND SURVEYORS ACT AT THE REQUEST OF THE DEPARTMENT OF TRANSPORTATION IN NOVEMBER 1997

(SIGNED AND SEALED) John Robert Lehti
 L.S. No. 5582
 LICENSE EXPIRATION DATE 12/31/2005

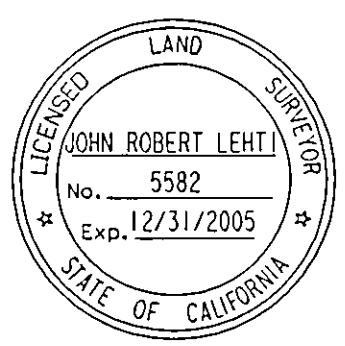

ADDITIONAL INFORMATION MAY BE OBTAINED FROM FILE 97263340 IN THE CALTRANS DISTRICT 2 SURVEYS OFFICE

THIS R.O.S. WAS PREPARED AND FILED TO SATISFY SECTION 8813 OF THE PUBLIC RESOURCES CODE FOR SUBSEQUENT SURVEYING SEGMENTS OF PROJECT E.A. 26334 AND MAKES NO TIES TO TITLE LINES

BEARINGS, DISTANCES, AND COORDINATES ARE BASED ON THE CALIFORNIA COORDINATE SYSTEM OF 1983, ZONE I, EPOCH 1991.35-CCS 83 ZONE I (1991.35)

THIS SURVEY MEETS OR EXCEEDS THE GROUP "C" ORDER 2-1 ACCURACY STANDARD AS DEFINED IN THE FEDERAL GEODETIC CONTROL SUBCOMMITTEE PUBLICATION "GEOMETRIC GEODETIC ACCURACY STANDARDS AND SPECIFICATIONS FOR USING GPS RELATIVE POSITIONING TECHNIQUES" REPRINTED WITH CORRECTIONS ON AUGUST 1, 1989 AND CONFORMS TO SECOND ORDER SURVEYS AS DEFINED IN THE CALIFORNIA DEPARTMENT OF TRANSPORTATION DRAFT SPECIFICATIONS FOR GPS SURVEYS DATED JUNE 1997.

STATE OF CALIFORNIA
 BUSINESS, TRANSPORTATION, AND HOUSING AGENCY
 DEPARTMENT OF TRANSPORTATION, DISTRICT 02
**RECORD OF SURVEY OF A
 GPS PROJECT CONTROL SURVEY**
 IN THE UNINCORPORATED TERRITORY OF THE COUNTY OF PLUMAS, STATE OF CALIFORNIA
 ALONG HIGHWAY 70 PM 77.9/91.2
 IN SECTIONS 26, 27, 29 T23N, R14E;
 SECTIONS 26, 30, 33 T23N, R15E;
 AND SECTIONS 28, 33 T23N, R16E
 OF THE MOUNT DIABLO BASE AND MERIDIAN
 DATE 16 JANUARY 2003 SHEET 1 OF 1

