

# LEGEND

- SET MONUMENT - SEE CORNER NOTES
- FOUND CORNER - SEE CORNER NOTES
- CALCULATED POINT
- (XX) CORNER NUMBER
- ( )1 RECORD PER 5 RS 143
- ( )2 RECORD PER GLO
- ( )3 RECORD PER 4 RS 66

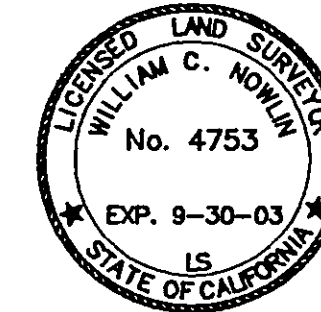

## SURVEYOR'S STATEMENT

THIS MAP CORRECTLY REPRESENTS A SURVEY MADE BY ME OR UNDER MY DIRECTION IN CONFORMANCE WITH THE REQUIREMENTS OF THE PROFESSIONAL LAND SURVEYORS' ACT AT THE REQUEST OF THE US FOREST SERVICE IN AUGUST, 2003.

SIGNED William C. Nowlin  
WILLIAM C. NOWLIN, L.S. 4753

## COUNTY SURVEYOR'S STATEMENT

THIS MAP HAS BEEN EXAMINED IN ACCORDANCE WITH SECTION 8766 OF THE PROFESSIONAL LAND SURVEYORS' ACT THIS 14<sup>th</sup> DAY OF November, 2003.

SIGNED R. Tom Hunter  
PLUMAS COUNTY SURVEYOR  
R. TOM HUNTER, R.C.E. 30515  
REG. EXP. 3/31/04

## COUNTY RECORDER'S STATEMENT

FILED THIS 19<sup>th</sup> DAY OF November, 2003,  
AT 2:26 P. M., IN BOOK 13 OF RECORD OF  
SURVEYS AT PAGE 6-7, AT THE REQUEST OF  
THE PLUMAS COUNTY SURVEYOR.

PLUMAS COUNTY RECORDER  
KATHLEEN WILLIAMS

By Jelly Wilkinsen  
DEPUTY

FEE \$ 10.00 DOC. # 2003-13980

## BASIS OF BEARINGS

CALIFORNIA ZONE 1, NAD 83 GRID BEARINGS  
DERIVED FROM FAST STATIC G.P.S. OBSERVATIONS.  
EPOCH DATE: 1991.35  
ADJUSTMENT DATE: AUGUST, 2001  
MAPPING ANGLES SHOWN AT CORNER NUMBERS 9  
AND 22.  
ALL DISTANCES SHOWN AS MEASURED ARE GRID  
DISTANCES. TO CONVERT TO GROUND, DIVIDE  
DISTANCES SHOWN BY 0.99985.

# RECORD OF SURVEY

FOR

USDA FOREST SERVICE  
PLUMAS NATIONAL FOREST

"McNAIR"

IN SECTION 35, T 22 N, R 8 E,  
AND SECTIONS 3, T 21 N, R 8 E, MDM IN  
THE UNINCORPORATED AREA OF  
PLUMAS COUNTY,  
STATE OF CALIFORNIA

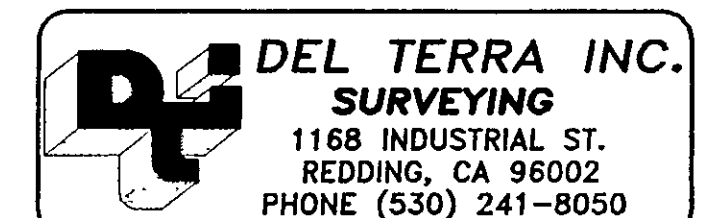

SCALE: 1" = 800' DATE: AUGUST, 2001  
SHEET 1 OF 2

