

VICINITY MAP & TIES TO CORS STATIONS

NO SCALE

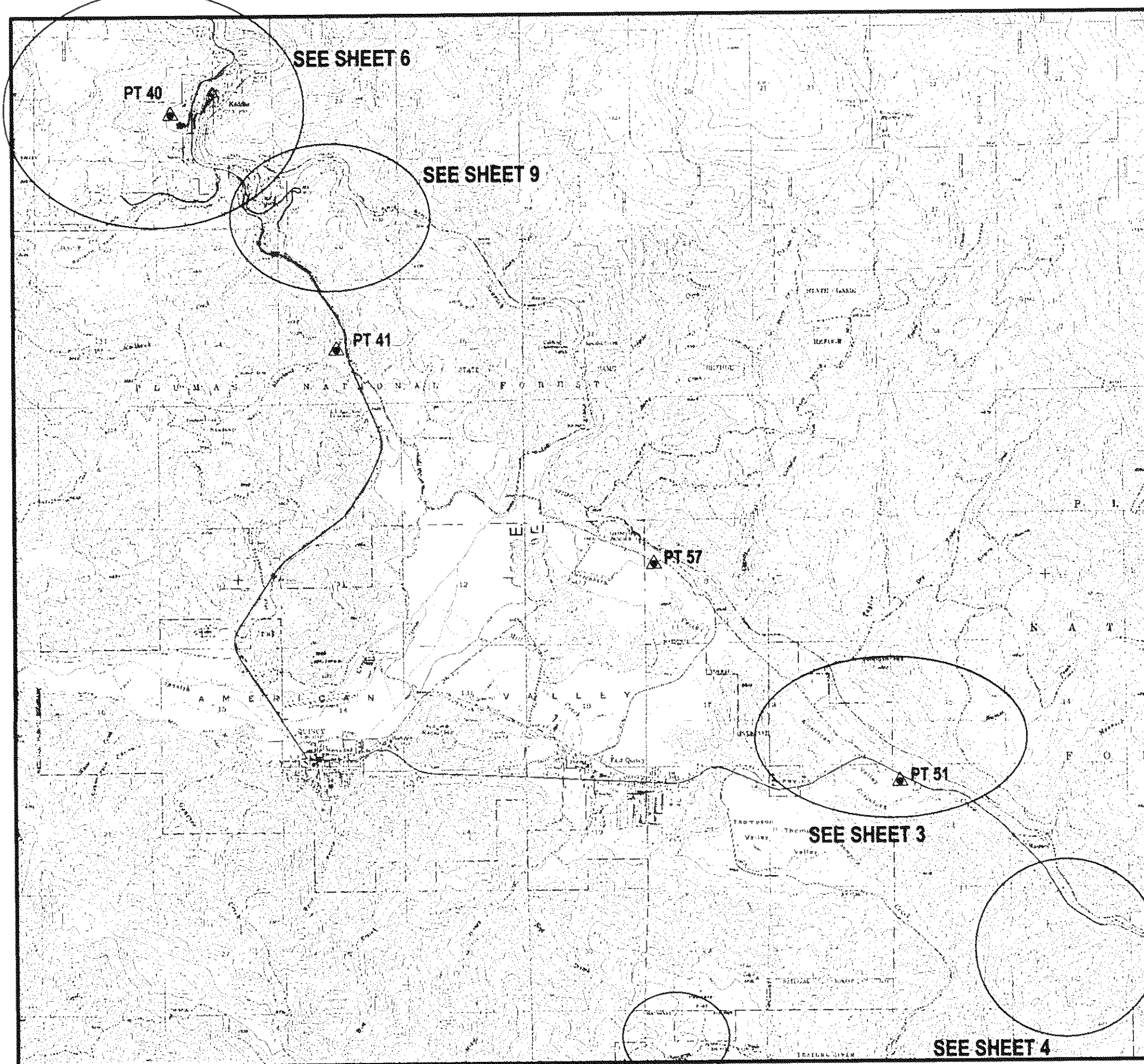

▲ PT 50
 Lat. 39°56'09.2115"N
 Long. 120°51'37.7508"W
 N 1862009.97 sft
 E 6881210.94 sft
 SET 5/8" X 30" REBAR W/ YPC, BURIED
 33" IN GROUND

▲ PT 52
 Lat 39°57'00.5302"N
 Long 120°47'59.3299"W
 N 1867429.63 sft
 E 6898152.65 sft
 SET 10" SPIKE IN STUMP

▲ PT 57
 Lat 39°57'36.0877"N
 Long 120°53'40.5557"W
 N 1870677.83 sft
 E 6871534.69 sft
 SET 5/8" X 30" REBAR W/ YPC, BURIED
 33" IN GROUND

▲ PT 40
 Lat 40°00'49.6988"N
 Long 120°58'08.1698"W
 N 1890014.07 sft
 E 6850466.81 sft
 SET 3/4" X 30" ALUMINUM DRIVE ROD, W/
 BREAK-AWAY BASE W/ YPC, BURIED 34" IN
 GROUND

▲ PT 41
 Lat 39°59'08.0554"N
 Long 120°56'38.9991"W
 N 1879812.08 sft
 E 6857528.36 sft
 SET 5/8" X 30" REBAR W/ YPC, BURIED
 34" IN GROUND

▲ NOT ON VICINITY MAP
 QUIN (CORS 2002)
 Lat 39°58'28.37874"N
 Long 120°56'39.88710"W
 Ellip. Ht 1106.33m

▲ NOT ON VICINITY MAP
 CHO1 - (CORS 2002)
 Lat 39°25'57.48322"N
 Long 121°39'53.81026"W
 Ellip. Ht. 16.96 m

Record of Survey

Empire Cadastral Survey

Sec. 21, 22 & 26, T. 25 N., R. 9 E.

Sec. 15, 16, 22, 26, 29 & 32, T. 24 N., R. 10E.

Mt. Diablo Meridian, California

NARRATIVE

Purpose & Procedure

See each individual section map for the procedure that was specific to each area.

The purpose of this survey is to monument and post portions of the boundary of the Plumas National Forest. This survey was performed under U.S.D.A. Forest Service contract No. 53-9SCP-04-1K-189. John Schmidt, LS is the Contracting Officer's Representative (COR). The Contracting Officer (CO) is Charlotte Carter. Chesebro & Kalb, Land Surveyors & Boundary Consultants of Mill City, Oregon, were joint venturers, providing resources, direct assistance, and consultation to Wallowa Associates throughout the project and to completion.

This survey was performed to USFS Cadastral Survey Specifications, California Business and Professions Code, and followed the "Standards and Guidelines for Cadastral Surveys using Global Positioning System Methods, Version 1.0, March 31, 2001, as adopted by the USDA Forest Service". Lines shown as Posted were posted with six foot galvanized channel posts and property boundary signs at intervals not exceeding 250 feet.

This survey was performed by a combination of GPS and conventional ground survey methods. Trimble 4800 and Ashtech Z12 dual frequency receivers were used to establish control and position monumentation. A Nikon 420 Total Station with TDS 48 and Recon data collectors were utilized for conventional ground surveys and monument positioning.

The geographic positions shown hereon were derived by static GPS methods and controlled by carrier-phase observation data downloaded from the U.S. national Geodetic Survey (NGS) Continuously Operating Reference Stations (CORS) CHICO 1 (CHO1) and QUINCY (QUIN).

Basis of Bearing

The Basis of Bearing was derived from GPS observations. State Plane Coordinates (CCS83 Zone 1) were calculated and then converted to ground bearing and distances using a convergence angle and combined scale factor for each area. See individual section maps for specifics.

History

See each individual section map for the history of each area surveyed.

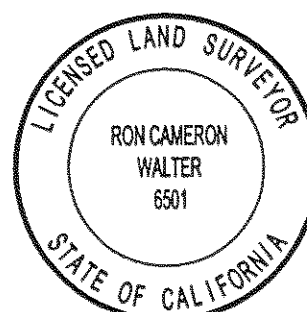
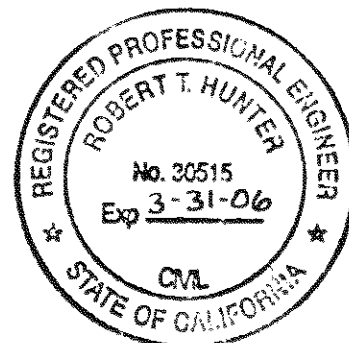

RECORDER'S STATEMENT

Filed this 9th day of Sept., 2005, at 11:44am
 in book 13 of Record of Surveys at page(s)
 123-122, at the request of the Plumas County Surveyor.

Fee: 26.00
 Document No.: 2005-9645

Kathleen Williams
 County Clerk - Recorder

By: *[Signature]*
 Deputy

COUNTY SURVEYOR'S STATEMENT

This map has been examined in accordance with Section 8766 of the Professional Land Surveyor's Act this 9th day of Sept., 2005.

[Signature]
 Tom Hunter RCE 35015
 License Exp. Date: 3/31/2006

SURVEYOR'S STATEMENT

This map correctly represents a survey made by me or under my direction in conformance with the requirements of the Professional Land Surveyor's Act at the request of the U.S.D.A. Forest Service in September, 2004 to May, 2005.

[Signature]
 Ron C. Walter
 L.S. 6501
 License Exp. Date: June 30, 2007

ABBREVIATIONS

BLM - BUREAU OF LAND MANAGEMENT
 BT - BEARING TREE
 BO - BEARING OBJECT
 CH - CHAINS (1 CH = 66 FT)
 FT - FEET
 GLO - GENERAL LAND OFFICE
 GPS - GLOBAL POSITION SYSTEM
 LKS - LINKS (100 LKS = 1 CH)
 LSM - LAND SURVEY MONUMENT SIGN
 M - METERS

NFSL - NATIONAL FOREST SYSTEM LANDS

NOAA - NATIONAL OCEANIC & ATMOSPHERIC ADMIN.
 PB - PROPERTY BOUNDARY
 ROS - RECORD OF SURVEY
 USDI - U.S. DEPT. OF THE INTERIOR
 USDA - U.S. DEPT. OF AGRICULTURE
 YPC - YELLOW PLASTIC CAP

Wallowa Associates
 P.O. Box 847
 Joseph, Oregon 97846
 (541)426-9049

**PLUMAS NATIONAL FOREST
 EMPIRE CADASTRAL SURVEY**

LOCATED WITHIN
 SEC. 21, 22 & 26, T. 25 N., R. 9 E.
 SEC. 15, 16, 22, 26, 29 & 32, T. 24 N., R. 10E.
 Mt. Diablo Meridian, California

SCALE VARIES	SHEET No. 1 of 10	DATE OF SURVEY Beginning: NOVEMBER 2004 Ending: MAY 2005
DRAWN BY ERK DATE 6/2005	CHECKED RW/EK/RC	PROJECT No. WA 1420