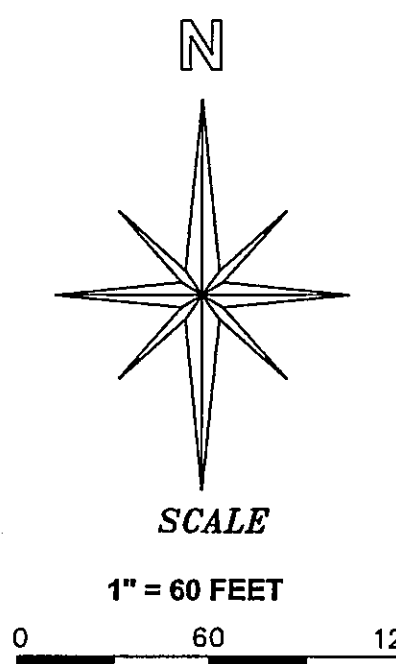

NOTE:

THE LOCATION OF THIS PARCEL IS BASED ON THE PRIMARY DEED CALLS TO THE CENTER LINE OF JACKS DITCH AND THE SOUTHERLY SIDE OF THE QUINCY - OROVILLE RD. THE CHARACTER AND POSITION OF THE EAST 1/4 CORNER OF SECTION 22, T24N R8E MDM, AS PER THE 1943 PARENT DEED OF 232 OR 95 IS UNKNOWN. THE ORIGINAL GLO 1/4 CORNER WAS RECOVERED ON 8/28/1981 AS PER 6 RS 14 AND IS REFERENCED IN THIS SURVEY. THE EXCEPTION (R3) REFERRED TO IN 232 OR 95 WAS NOT REFERENCED IN THIS SURVEY.

**BASIS OF BEARINGS**

THE CALCULATED LINE BETWEEN THE E 1/4 MONUMENT AND THE S.E. 1/16 MONUMENT OF SECTION 22 T24N R8E MDM AS DETERMINED FROM 6 RS 14 BEING S44°53'42"W.

LEGEND

- ☑ FD. STANDARD U.S.F.S. MONUMENT (R1)
- └─┘ CALCULATED CORNER - JACKS DITCH
- ⊙ SET 5/8" REBAR W/ 1 1/2" ALUMINUM CAP MKD. LS 6569
- SET 5/8" REBAR W/ 1 1/2" PLASTIC CAP MKD. LS 6569
- ▲ MAG NAIL W/WASHER MKD. LS 6569 (EDGE OF PAVEMENT) (R2)
- PROPERTY BOUNDARY
- (R1) 6 RS 14
- (R2) 232 OR 95
- (R3) 138 OR 223
- (R&M) RECORD & MEASURED PER (R2) & (R3)
- RM REFERENCE MONUMENT

STANDARD U.S.F.S. MONUMENT

A STANDARD U.S. FOREST SERVICE MONUMENT IS A 2-1/2" DIAMETER ALUMINUM PIPE, 30" LONG WITH 3-1/4" ALUMINUM CAP EDGE-MARKED WITH THE US FOREST SERVICE LOGO.

MEMORANDUM OF OATH

I DONNA MC ELROY, A LIFE LONG RESIDENT OF MEADOW VALLEY, CA. HEREBY TESTIFY THAT THE CURENT LOCATIONS OF JACKS DITCH AND THE QUINCY - OROVILLE RD. HAVE REMAINED UNCHANGED FOR OVER 60 YEARS.

by Donna Mc Elroy DATE 8-27-10

DETAIL A

EXISTING
71"X44" CMPA

9 PM 103

1.08 Acres.

502 OR 516

586 OR 293

586 OR 293

NOTE:

THE PLUMAS COUNTY DEPARTMENT OF PUBLIC WORKS CONTENTS THAT THERE ARE CERTAIN PRESCRIPTIVE RIGHTS ALONG THE BUCKS LAKE ROAD. THE PURPOSE OF THIS SURVEY IS TO MONUMENT PROPERTY CORNERS AS DESCRIBED IN 232 OR 95 EXCLUDING EXCEPTION 138 OR 223. THIS RECORD OF SURVEY DETERMINES THE LOCATION OF THESE MONUMENTS AND IS NOT INTENDED, NOR MEANT TO REFLECT ANY ADDITIONAL RIGHTS OF WAY OF THE COUNTY OF PLUMAS THAT EFFECT RECORD TITLE INTEREST.

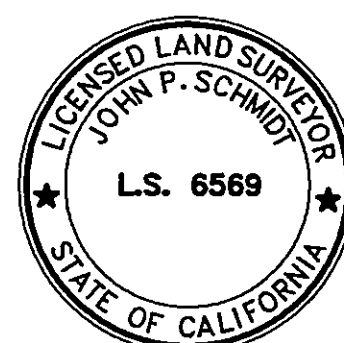
**SURVEYOR'S STATEMENT**

THIS MAP CORRECTLY REPRESENTS A SURVEY MADE BY ME OR UNDER MY DIRECTION IN CONFORMANCE WITH THE REQUIREMENTS OF THE PROFESSIONAL LAND SURVEYORS' ACT AT THE REQUEST OF JANET I. KANE IN SEPTEMBER 2009.

AUGUST 24, 20 10

John P. Schmidt
JOHN P. SCHMIDT LS 6569

COUNTY SURVEYOR'S STATEMENT

THIS MAP HAS BEEN EXAMINED IN ACCORDANCE WITH SECTION 8766 OF THE PROFESSIONAL LAND SURVEYOR'S THIS 24th DAY OF Sept. 2010.

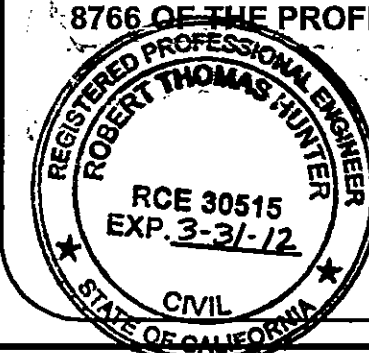

BY Robert Thomas Hunter
ROBERT THOMAS HUNTER
PLUMAS COUNTY SURVEYOR RCE 30515

RECORDER'S STATEMENT

FILED THIS 13 DAY OF Sept. 20 10 AT 1:18 P.M. IN BOOK 15 OF RECORDS OF SURVEYS, AT PAGE 60 AT THE REQUEST OF THE COUNTY SURVEYOR.

FEE: \$8.00

KATHLEEN WILLIAMS
COUNTY RECORDER

DOC. No: 2010-0005555

BY: Laura Foster
DEPUTY

RECORD OF SURVEY

THAT PORTION OF S.E. 1/4 OF THE NW 1/4 OF THE SE 1/4 SECTION 22, T24N R8E, MDM PLUMAS COUNTY, CALIFORNIA DESCRIBED IN VOL. 232 BOOK PAGE 95 O.R. & EXCEPTING 138 O.R. 223

FOR
JANET I. KANE
P.O. BOX 291
MEADOW VALLEY, CA. 95956

DRAWN BY: B. SNOW

DATE: 5-18-2010

SHEET 1 OF 1