

12

John W. Hamby - L. S. 2843

This map has been examined for conformance with the requirements of Chapter 15 of Division 3 of the Business and Professions code this 16<sup>th</sup> day of August, 1966.

*Lawrence J. Brock*  
Lawrence J. Brock, P.C.E. 13528

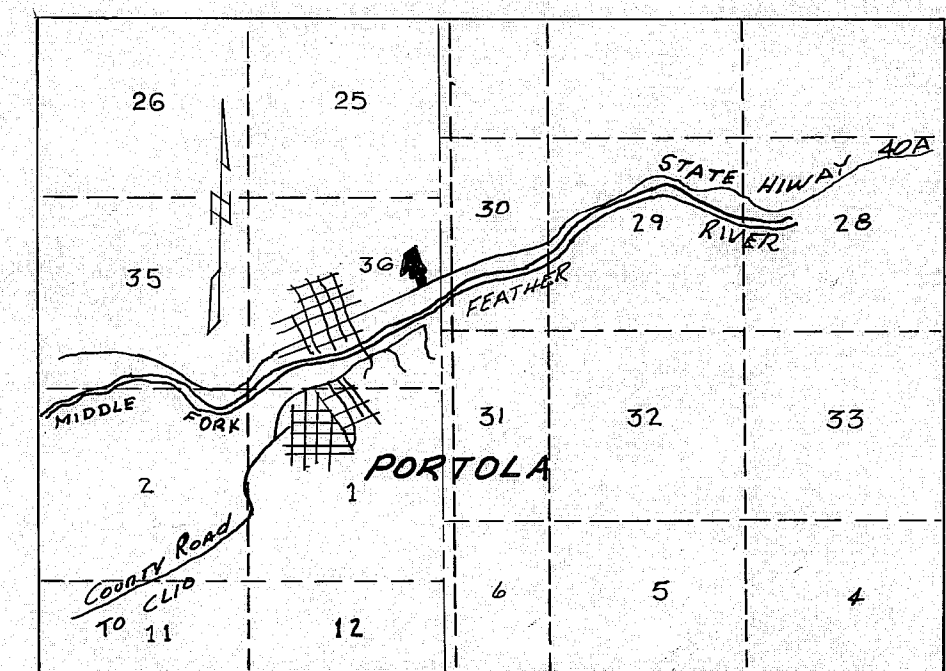

LOCATION MAP  
SCALE 1" = 5280'

# 739

Filed and recorded at the request of  
John W. Hamby  
this 17<sup>th</sup> day of August, 1966, at  
11:01 o'clock A m, in volume 1 of  
Parcel Maps, at page 42 Plumas  
County Records.

rs.  
Ida Hagen Gronwald  
Recorder of the County of Plumas  
State of California

By \_\_\_\_\_ Deputy

○ SET 3/4" I.P. MARKED L.S. 2843  
● FOUND 3/4" IRON PIPE.

THE BASIS OF BEARING IS THE  
NORTH LINE OF "PARKSIDE  
TERRACE SUBDIVISION UNIT #1"

丁巳年 丁巳月 丁巳日 丁巳時 丁巳時  
 丁巳年 丁巳月 丁巳日 丁巳時 丁巳時

# PARCEL MAP

A PORTION OF THE E 1/2 OF SEC. 36  
T23N R13E MDB&M.

FOR  
AL JOY  
PDRTO LA PLUMAS CO. CALIF.  
SCALE 1"= 50' JUNE 1966

JOHN W HAMBY L.S.2843  
LICENSED LAND SURVEYOR  
651 PEARSON ROAD  
PARADISE CALIF.

1 PM 4/2